

capacity of U-PVC DLP trunking systems for installation

■ New standard EN 50085-2-1

Classification EN 50085-2-1		Level
6.1	Void	
6.2	Resistance to impact for installation and application	2.0 J
6.3	Minimum storage and transport temperature	- 25 °C
6.3	Minimum installation and application temperature	- 5 °C
6.3	Maximum application temperature	+ 60 °C
6.4	Resistance to flame propagation	Non-flame propagating
6.5	Electrical continuity characteristic	Without electrical continuity characteristic
6.6	Electrical insulating characteristic	With electrical insulating characteristic
6.7	Degrees of protection provided by enclosure	IP 40
6.9	System access cover retention	With a tool
6.101	Position when surface mounted	Wall fixed, ceiling fixed, wall fixed and supported by the floor or other horizontal surface
6.102	Prevention of contact between liquids and insulated conductors and live parts in case of CTS/CDS mounted in a skirting position and wet-treatment of floor	Instructions restricting the installation position
6.103	The functions provided	Type 2: 0 104 32/33/52/53, type 3: other Cat.Nos
Rated current		500 V
Against mechanical shocks		IK 07

Type 1, type 2 distribution, type 3 installation

Insulation resistance : all the DLP plastic range (including accessories) insulation resistance superior to 5 megohms

CV : Cover

1 Cross-section in mm² (or diameter for ELV cables) depending on number of conductors

Normal cross-section of cores (mm ²)	Cable									
	1 conductor		2 conductors		3 conductors		4 conductors		5 conductors	
	Usable cross-section (mm ²)	Maximum Ø (mm)	Usable cross-section (mm ²)	Maximum Ø (mm)	Usable cross-section (mm ²)	Maximum Ø (mm)	Usable cross-section (mm ²)	Maximum Ø (mm)	Usable cross-section (mm ²)	Maximum Ø (mm)
1.5	44	6.6	111	10.5	121	11.0	144	12.0	169	13.0
2.5	49	7.0	133	11.5	157	12.5	169	13.0	211	14.5
4	58	7.6	169	13.0	183	13.5	211	14.5	256	16.0
6	68	8.2	196	14.0	225	15.0	256	16.0	307	17.5
10	85	9.2	256	16.0	289	17.0	343	18.5	400	20.0
16	111	10.5	43	18.5	381	19.5	441	21.0	529	23.0
25	157	12.5	484	22.0	553	23.5	651	25.5	784	28.0
35	183	13.5	601	24.5	676	26.0	813	28.5	993	31.5
50	225	15.0	-	-	841	29.0	1 057	32.5	-	-

Example

A - Description :
 2 cables 3 x 1.5² • 4 cables 4 x 2.5²
 10 cables 4 x 4²

B - Calculation of cumulative cable cross-sections:
 See table 1

	Theoretical cross-section (mm ²)	Practical cross-section (mm ²)
2 cables 3 x 1.5 ²	2 x 121 = 242	
4 cables 4 x 2.5 ²	4 x 169 = 676	
10 cables 4 x 4 ²	10 x 211 = 2 110	
TOTAL	3 028	3 330*

*K (filling factor) = 1.10 Section = 3 028 x 1.10 = **3 330 mm²**

C - Trunking selection
 See table 2

2 Capacity of trunking (CV : Cover)

	Cross-section (mm ²) Max. Ø (mm)	80 x 50		105 x 50			
		CV65	CV40	CV40	CV40	CV85	
Trunking only	Cross-section	3380	1930	1930	4330		
	Max. Ø	40	28	43	28		
With Arteor™ support	Cross-section	1830	1410	1410	2300		
	Max. Ø	2 x 18	2 x 21	2 x 21	2 x 24		

	Cross-section (mm ²) Max. Ø (mm)	150 x 50								
		CV40	CV40	CV40	CV65	CV65	CV40	CV85	CV130	
Trunking only	Cross-section	2000	1570	2000	3020	3020	2000	4020	6470	
	Max. Ø	28	28	43	43	2x43	43	28	28	
With Arteor™ support	Cross-section	1480	1050	1480	1470	1470	1480	1990	-	
	Max. Ø	24	2x17	24	18	18	24	26	-	

	Cross-section (mm ²) Max. Ø (mm)	195 x 50																		
		CV40	CV40	CV40	CV65	CV65	CV65	CV40	CV40	CV85	CV40	CV130	CV40	CV85	CV85	CV180				
Trunking only	Cross-section	2000	1570	1570	2000	3020	1570	3020	3020	2580	1570	2000	2000	3590	2000	6040	2000	4020	4020	8470
	Max. Ø	28	28	28	28	43	28	43	43	42	28	28	42	28	2 x 42	28	43	43	3 x 42	
With Arteor™ support	Cross-section	1480	1050	1050	1480	1470	1050	1470	1470	1030	1480	1480	1560	1480	-	1480	1990	1990	-	
	Max. Ø	2 x 21	2 x 17	2 x 17	2 x 21	18	2 x 17	18	18	14	2 x 21	2 x 21	2 x 18	2 x 21	-	2 x 21	26	26	-	

DLP U-VC adaptable trunking systems for installations

base, covers, partitions, finishing accessories and mounting wiring accessories

Selection chart for Installation of trunking, Accessories and Arteor™

Trunking			Covers		Clip on partition		Arteor™ frames				
Number of compartments	Cover(s) width	Section (mm)	Flexible	Partitions separation	Plastic	Aluminium	1 module	2 module	3 module	4 module	6 module
0104 12	1 1 x 65	80 x 50	0105 21	0105 82	-	-	-	0109 21	0109 31	0109 41	0109 61
0104 22	1 1 x 85	105 x 50	0105 22	0105 82	-	-	-	0109 22	0109 32	0109 42	0109 62
	2 2 x 40		0105 20	0105 82	0104 72	0111 06	0109 10	-	-	-	-
0104 32	1 1 x 130	150 x 50	0105 24	0105 82	-	-	-	-	-	-	-
	2 2 x 65		0105 21	0105 82	0104 72	0111 06	-	0109 21	0109 31	0109 41	0109 61
	2 1 x 40 + 1 x 85		0105 20 + 0105 22	0105 82	0104 72	0111 06	0109 10	0109 22	0109 32	0109 42	0109 62
	3 3 x 40		0105 20	0105 82	0104 72 x 2	0111 06 x 2	0109 10	-	-	-	-
0104 52	1 1 x 180	195 x 50	0105 26	0105 82	-	-	-	-	-	-	-
	2 2 x 85		0105 22	0105 82	0104 72	0111 06	-	0109 22	0109 32	0109 42	0109 62
	2 1 x 40 + 1 x 130		0105 20 + 0105 24	0105 82	0104 72	0111 06	0109 10	-	-	-	-
	3 1 x 85 + 2 x 40		0105 22 + 0105 20	0105 82	0104 72 x 2	0111 06 x 2	0109 10	0109 22	0109 32	0109 42	0109 62
	3 1 x 40 + 2 x 65		0105 20 + 0105 21	0105 82	104 72 x 2	111 06 x 2	0109 10	0109 21	0109 31	0109 41	0109 61
	4 4 x 40		0105 20	0105 82	0104 72 x 3	0111 06 x 3	0109 10	-	-	-	-

Selection chart for Installation trunking, Accessories and Arteor™

Section (mm)	Wall crossing	Capacity change to increase height of trunking	Partition junction for capacity change	Cable tie base	Insulating unit for Arteor™ modules		Earth link
					2 module can be added to get 4/6 module	3 module	
80 x 50 / 105 x 50	0106 98	0106 87 + 0106 88	0106 89	0308 81	0109 27	0109 37	0111 88
150 x 50 / 195 x 50	0106 99						

Bold catalogue numbers are products normally available with Legrand (India) stockists.
Cat.Nos that are not bold - delivery within 4 - 8 weeks from the date of order.
Bold packing quantity is our mandatory packing. Orders to be placed by Legrand (India) stockists in multiples of the same.

Selection chart for Installation of trunking, Additional accessories

Cover	Bases		Internal angles 80° - 100°			External angles 60° - 120			Flat angles		Flat junction			Clips
	Joint for covers	Base joint	End caps	Angles	Partition junction	VDI access.	Angles	Partition junction	VDI access.	Angles	VDI access.	Angles	Partition junction	
0108 01	0106 91	0107 22	0106 02	-	0107 80	0106 22	-	0107 81	0107 67	0107 82	0107 32	-	0107 83	0106 82
0108 02	0106 91	0107 02	0106 02	-	0107 80	0106 22	-	0107 81	0107 85	0107 82	0107 32	-	0107 83	0106 82
0108 00	0106 91	0107 02	0106 02	0106 11	-	0106 22	0106 32	-	-	-	0107 32	0107 42	-	0106 82
0108 04	0106 91	0107 06	0106 02	-	-	0106 22	-	-	0107 89	-	0107 32	-	-	0106 86
0108 01	0106 91	0107 06	0106 02	0106 11	0107 80	0106 22	0106 32	0107 81	0107 89	0107 82	0107 32	0107 42	0107 83	0106 82
0108 02	0106 91	0107 06	0106 02	0106 11	0107 80	0106 22	0106 32	0107 81	0107 89	0107 82	0107 32	0107 42	0107 83	0106 82
0108 00	0106 91	0107 06	0106 02	0106 11x2	-	0106 22	0106 32x2	-	0107 89	-	0107 32	0107 42	-	0106 82
0108 06	0106 91	0107 07	0106 02	-	-	0106 22	-	-	0107 92	-	0107 32	-	-	0106 86
0108 02	0106 91	0107 07	0106 02	0106 11	0107 80	0106 22	0106 32	0107 81	0107 92	0107 82	0107 32	0107 42	0107 83	0106 82
	0106 91	0107 07	0106 02	0106 11	0107 80	0106 22	0106 32	0107 81	0107 92	0107 82	0107 32	0107 42	0107 83	
	0106 91	0107 07	0106 02	0106 11x2	0107 80	0106 22	0106 32x2	0107 81	0107 92	0107 82	0107 32	0107 42	0107 83	0106 82
	0106 91	0107 07	0106 02	0106 11x2	0107 80	0106 22	0106 32x2	0107 81	0107 92	0107 82	0107 32	0107 42	0107 83	0106 82
0108 00	0106 91	0107 07	0106 02	0106 11x3	-	0106 22	0106 32x3	-	0107 92	-	0107 32	0107 42	-	0106 82

DLP U-PVC trunking system and accessories 80 x 50

trunking and fittings

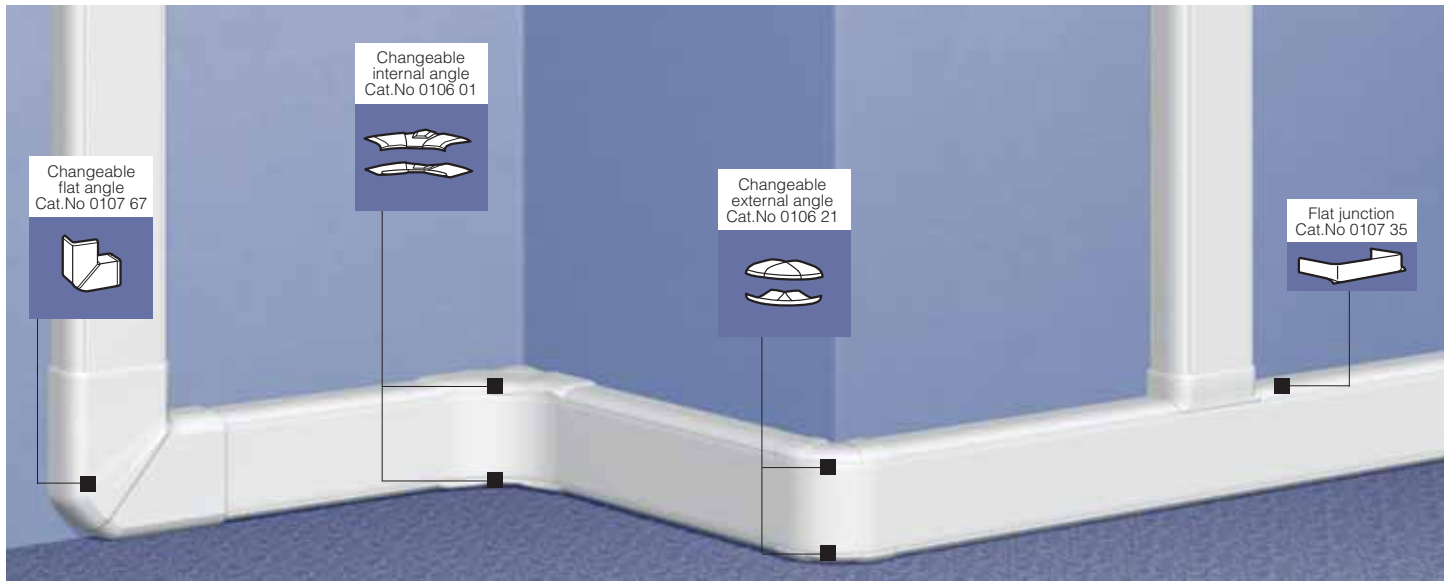

Selection table (p. 374-375)
Cable carrying capacity (p. 373)

Pack	Cat.Nos	Trunking
		Suitable for a wide range of requirements and applications: - Distribution: large wiring capacity and wide access to the wiring space - Installation: can be used with various ranges of wiring accessories - Flexible cover which continuous even on angles - Adjustable internal and external angles - U-PVC trunking
		Bodies Supplied without cover Length 2 m
20 ⁽¹⁾	0104 12	80 x 50 mm
		Flexible cover
20 ⁽¹⁾	0105 21	Fits onto the whole branch including in internal or external angles Full cover width 65 mm Length 2 m
		Partitions
24 ⁽¹⁾	0105 82	Separation partition for 80 x 50 trunking Length 2 m
		Joints
20/200	0106 91	Body joint, for aligning bases during installation For cover 65 mm width
10/100	0108 01	Cover joint

Angles and end caps		
		Internal and external angles Include the 2 components for the top and bottom of the trunking on which the flexible cover is fitted
10/40	0106 02	Internal angle, adjustable from 80° to 100°
10/50	0106 22	External angle, adjustable from 60° to 120°

Pack	Cat.Nos	Angles and end caps (continued)
		Flat angle
10	0107 67	90° flat angle
		End cap
10/50	0107 22	Left or right end cap
		Junctions
10	0107 32	Flat junctions
5/25	0107 35	For specific size tap-off to 80 mm wide branch
		Accessories
		Holding cables in place
50	0106 82	Clip
		VDI accessories
5/50	0107 80	For internal angles
5/50	0107 81	For external angles
5/50	0107 82	For flat angles
5/50	0107 83	For flat junctions
		Additional accessories
5/25	0106 98	Wall crossing
40	0106 87	Capacity change Capacity change
10/100	0106 88	
5/50	0106 89	Partition junction
100/1000	0308 81	Cable tie base
20/500	0111 88	Earthing link

(1) Number of meters in pack

DLP U-PVC trunking system and accessories 105 x 50
trunking and fittings



Selection table (p. 374-375)
Cable carrying capacity (p. 373)

Pack	Cat.Nos	Trunking
		Suitable for a wide range of requirements and applications: - Distribution: large wiring capacity and wide access to the wiring space - Installation: can be used with various ranges of wiring accessories - Flexible cover which continuous even on angles - Adjustable internal and external angles - U-PVC trunking
		Bodies Supplied without cover Length 2 m
20 ⁽¹⁾	0104 22	105 x 50 mm
		Flexible cover Fits onto the whole branch including in internal or external angles Full cover width 85 mm Two covers width 40 mm Length 2 m
20 ⁽¹⁾ 20	0105 22 0105 20	
		Partitions Separation partition for 105 x 50 trunking Length 2 m
24 ⁽¹⁾	0105 82	
48	0104 72	Plastic clip-on partition
12	0111 06	Aluminium clip-on partition
		Joints Body joint For aligning bases during installation
20/200	0106 91	
10/100	0108 02	Cover joint for 85 mm width
10/100	0108 00	Cover joint for 40 mm width

Pack	Cat.Nos	Angles and end caps (continued)
		Flat angle 90° flat angle
10	0107 85	
		End cap Left or right end cap
20/100	0107 02	
		Junctions Flat angles
10	0107 32	
		For tap-off to an 80 mm wide branch
5/25	0107 35	For 35 x 105 and 50 x 105 trunkings
		For tap-off to a 105 mm wide branch equipped with a 65 mm cover
5/25	0107 37	For 50 x 105 mm trunking
		For tap-off to an 105 mm wide branch equipped with an 85 mm cover
5/25	0107 36	For 35 x 105 and 50 x 105 trunkings
		Partion junction For internal angles
5/50	0106 11	
		For external angles
5/50	0106 32	
		For flat angles
5/25	0107 42	

Angles and end caps		
		Internal and external angles Include the 2 components for the top and bottom of the trunking on which the flexible cover is fitted
10/40	0106 02	Internal angle, adjustable from 80° to 100°
10/50	0106 22	External angle, adjustable from 60° to 120°

Accessories		
		Holding cables in place Clip
50	0106 82	
		VDI accessories For internal angles
5/50	0107 80	
		For external angles
5/50	0107 81	
		For flat angles
5/50	0107 82	
		For flat junctions
5/50	0107 83	

(1) Number of meters in pack

Bold catalogue numbers are products normally available with Legrand (India) stockists.
Cat. nos. that are not bold - delivery within 4 - 8 weeks from the date of order.

Bold packing quantity is our mandatory packing. Orders to be placed by Legrand (India) stockists in multiples of the same.

DLP U-PVC adaptable trunking system and accessories 150 x 50

trunking and fittings



Selection table (p. 374-375)
Cable carrying capacity (p. 373)

Pack	Cat.Nos	Trunking
		Suitable for a wide range of requirements and applications: - Distribution: large wiring capacity and wide access to the wiring space - Installation: can be used with various ranges of wiring accessories - Flexible cover which continuous even on angles - Adjustable internal and external angles - U-PVC trunking
		Bodies Supplied without cover Length 2 m
20 ⁽¹⁾	0104 32	150 x 50 mm
		Flexible cover Fits onto the whole branch including in internal or external angles
8	0105 24	Full cover width 130 mm
20	0105 22	Full cover width 85 mm
20	0105 21	Full cover width 65 mm
20	0105 20	Full cover width 40 mm Length 2 m
		Partitions
24 ⁽¹⁾	0105 82	Separation partition for 105 x 50 trunking Length 2 m
48	0104 72	Plastic clip-on partition
12	0111 06	Aluminium clip-on partition
		Joints
20/200	0106 91	Body joint For aligning bases during installation
10/100	0108 04	Cover joint for 130 mm width
10/100	0108 02	Cover joint for 85 mm width
10/100	0108 01	Cover joint for 65 mm width
10/100	0108 00	Cover joint for 40 mm width

Angles and end caps		
Internal and external angles Include the 2 components for the top and bottom of the trunking on which the flexible cover is fitted		
10/40	0106 02	Internal angle, adjustable from 80° to 100°
10/50	0106 22	External angle, adjustable from 60° to 120°

Pack	Cat.Nos	Angles and end caps (continued)
5	0107 89	Flat angle 90° flat angle
10/50	0107 06	End cap Left or right end cap
Junctions		
10	0107 32	Flat angles
5/25	0107 35	To tap-off to an 80 mm wide branch
5/25	0107 37	To tap-off to a 105 mm wide branch equipped with a 65 mm cover
5/25	0107 36	To a tap-off to a 105 mm wide branch equipped with a 85 mm cover
Partion junction		
5/50	0106 11	For internal angles
5/50	0106 32	For external angles
5/25	0107 42	For flat angles

Accessories		
Holding cables in place		
50	0106 86	Clip for 130 mm width cover
50	0106 82	Clip for 65 mm width cover
VDI accessories		
5/50	0107 80	For internal angles
5/50	0107 81	For external angles
5/50	0107 82	For flat angles
5/50	0107 83	For flat junctions

(1) Number of meters in pack

(1) Number of meters in pack

Bold catalogue numbers are products normally available with Legrand (India) stockists.
Cat. nos. that are not bold - delivery within 4 - 8 weeks from the date of order.

Bold packing quantity is our mandatory packing. Orders to be placed by Legrand (India) stockists in multiples of the same.

DLP U-PVC adaptable trunking system and accessories 195 x 50

trunking and fittings

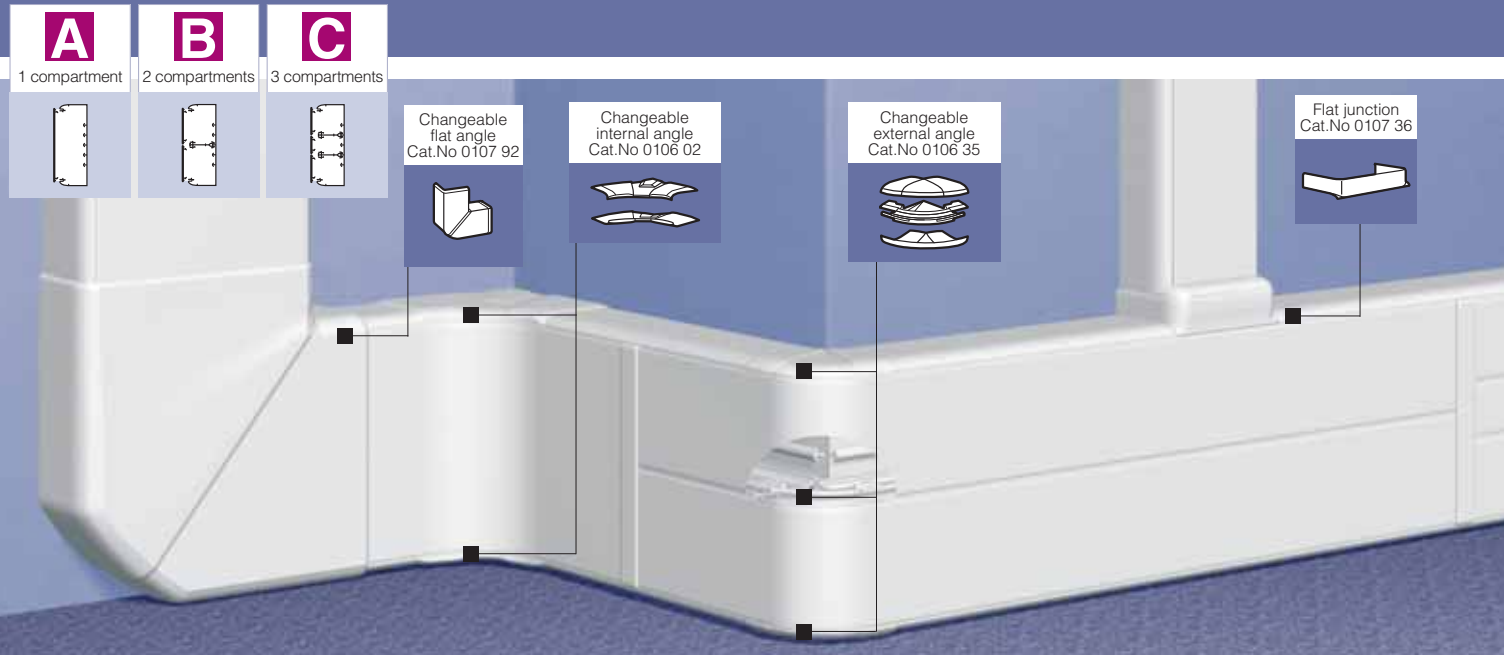

Selection table (p. 374-375)
Cable carrying capacity (p. 373)

Pack	Cat.Nos	Trunking
		Suitable for a wide range of requirements and applications: - Distribution: large wiring capacity and wide access to the wiring space - Installation: can be used with various ranges of wiring accessories - Flexible cover which continuous even on angles - Adjustable internal and external angles
8	0104 52	Bodies Supplied without cover Length 2 m 195 x 50 mm
		Flexible cover Fits onto the whole branch including in internal or external angles
8	0105 26	Full cover width 180 mm
20	0105 22	Full cover width 85 mm
8	0105 24	Full cover width 130 mm
20	0105 21	Full cover width 65 mm
20	0105 20	Full cover width 40 mm
		Length 2 m
		Partitions
24 ⁽¹⁾	0105 82	Separation partition for 195 x 50 trunking Length 2 m
48	0104 72	Plastic clip-on partition
12	0111 06	Aluminium clip-on partition
		Joints
20/200	0106 91	Body joint For aligning bases during installation
10/100	0108 06	Cover joint for 180 mm width
10/100	0108 02	Cover joint for 85 mm width
10/100	0108 04	Cover joint for 130 mm width
10/100	0108 01	Cover joint for 65 mm width
10/100	0108 00	Cover joint for 40 mm width

Angles and end caps	
Internal and external angles Include the 2 components for the top and bottom of the trunking on which the flexible cover is fitted	
10/40	0106 02 Internal angle, adjustable from 80° to 100°
10/50	0106 22 External angle, adjustable from 60° to 120°

Pack	Cat.Nos	Angles and end caps (continued)
2	0107 92	Flat angle 90° flat angle
5/50	0107 07	End cap Left or right end cap
Junctions		
10	0107 32	Flat angles
5/25	0107 35	To tap-off to an 80 mm wide branch
5/25	0107 37	To tap-off to a 105 mm wide branch equipped with a 65 mm cover
5/25	0107 36	To a tap-off to a 105 mm wide branch equipped with a 85 mm cover
Partion junction		
5/50	0106 11	For internal angles
5/50	0106 32	For external angles
5/25	0107 42	For flat angles
Accessories		
Holding cables in place		
50	0106 86	Clip for 130 mm width cover
50	0106 82	Clip for 40 mm width cover
VDI accessories		
5/50	0107 80	For internal angles
5/50	0107 81	For external angles
5/50	0107 82	For flat angles
5/50	0107 83	For flat junctions

Bold catalogue numbers are products normally available with Legrand (India) stockists.
Cat. nos. that are not bold - delivery within 4 - 8 weeks from the date of order.

Bold packing quantity is our mandatory packing. Orders to be placed by Legrand (India) stockists in multiples of the same.