

### Selection chart for Installation of trunking, Additional accessories

Cover	Bases		Internal angles 80° - 100°			External angles 60° - 120			Flat angles		Flat junction			Clips
	Joint for covers	Base joint	End caps	Angles	Partition junction	VDI access.	Angles	Partition junction	VDI access.	Angles	VDI access.	Angles	Partition junction	
0108 01	0106 91	0107 22	0106 02	-	0107 80	0106 22	-	0107 81	0107 67	0107 82	0107 32	-	0107 83	0106 82
0108 02	0106 91	0107 02	0106 02	-	0107 80	0106 22	-	0107 81	0107 85	0107 82	0107 32	-	0107 83	0106 82
0108 00	0106 91	0107 02	0106 02	0106 11	-	0106 22	0106 32	-	-	-	0107 32	0107 42	-	0106 82
0108 04	0106 91	0107 06	0106 02	-	-	0106 22	-	-	0107 89	-	0107 32	-	-	0106 86
0108 01	0106 91	0107 06	0106 02	0106 11	0107 80	0106 22	0106 32	0107 81	0107 89	0107 82	0107 32	0107 42	0107 83	0106 82
0108 02	0106 91	0107 06	0106 02	0106 11	0107 80	0106 22	0106 32	0107 81	0107 89	0107 82	0107 32	0107 42	0107 83	0106 82
0108 00	0106 91	0107 06	0106 02	0106 11 x 2	-	0106 22	0106 32 x 2	-	0107 89	-	0107 32	0107 42	-	0106 82
0108 06	0106 91	0107 07	0106 02	-	-	0106 22	-	-	0107 92	-	0107 32	-	-	0106 86
0108 02	0106 91	0107 07	0106 02	0106 11	0107 80	0106 22	0106 32	0107 81	0107 92	0107 82	0107 32	0107 42	0107 83	0106 82
	0106 91	0107 07	0106 02	0106 11	0107 80	0106 22	0106 32	0107 81	0107 92	0107 82	0107 32	0107 42	0107 83	
	0106 91	0107 07	0106 02	0106 11 x 2	0107 80	0106 22	0106 32 x 2	0107 81	0107 92	0107 82	0107 32	0107 42	0107 83	0106 82
	0106 91	0107 07	0106 02	0106 11 x 2	0107 80	0106 22	0106 32 x 2	0107 81	0107 92	0107 82	0107 32	0107 42	0107 83	0106 82
0108 00	0106 91	0107 07	0106 02	0106 11 x 3	-	0106 22	0106 32 x 3	-	0107 92	-	0107 32	0107 42	-	0106 82

## DLP mini trunking systems for cable distribution

### Selection chart for DLP mini trunking

Length	Finishing Accessories				Junction Elements		
<b>WHITE</b>	<b>2 m</b>	<b>End cap</b>	<b>Internal angle</b>	<b>External angle</b>	<b>Flat angle</b>	<b>Flat junction</b>	
32 x 12.5		0300 15	0312 03	0302 51	0302 51	0302 53	0302 54
32 x 16		0308 04	0312 07	0333 25	0333 25	0333 27	0333 30
32 x 20		0300 17	0312 09	0302 71	0302 71	0302 73	0302 74

# DLP U-PVC trunking system and accessories 80 x 50

trunking and fittings

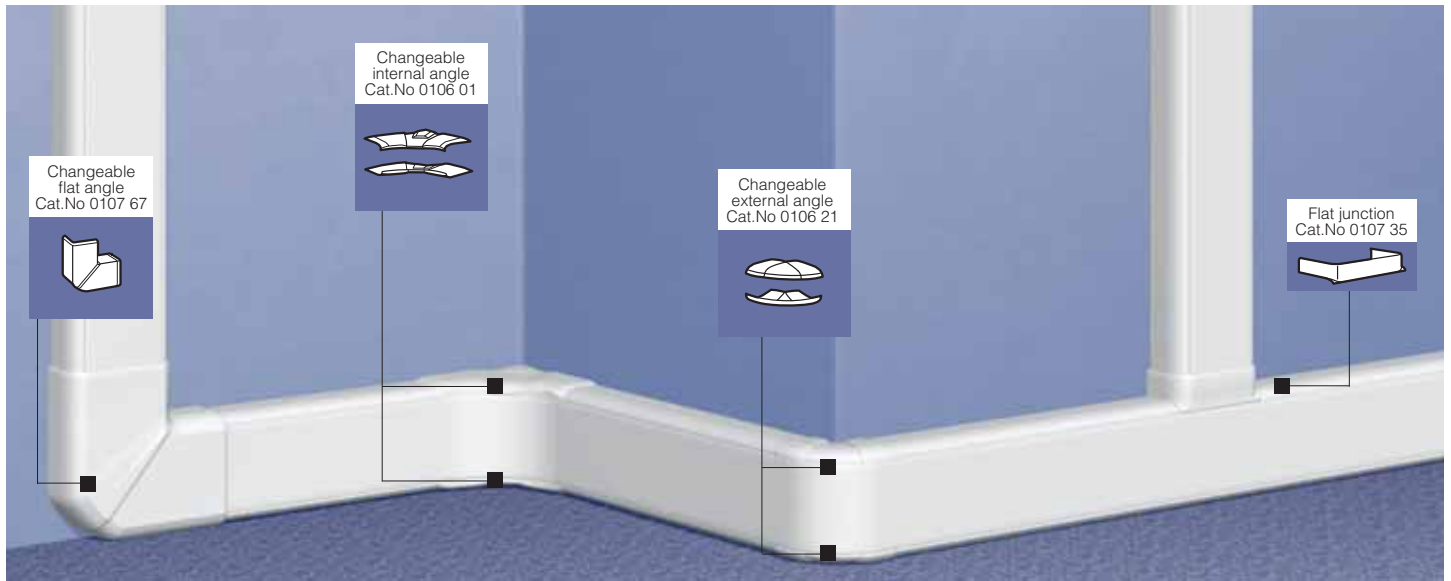

Selection table (p. 374-375)  
Cable carrying capacity (p. 373)

Pack	Cat.Nos	Trunking
		Suitable for a wide range of requirements and applications: - Distribution: large wiring capacity and wide access to the wiring space - Installation: can be used with various ranges of wiring accessories - Flexible cover which continuous even on angles - Adjustable internal and external angles - U-PVC trunking
		<b>Bodies</b> Supplied without cover Length 2 m
20 <sup>(1)</sup>	0104 12	80 x 50 mm
		<b>Flexible cover</b>
20 <sup>(1)</sup>	0105 21	Fits onto the whole branch including in internal or external angles Full cover width 65 mm Length 2 m
		<b>Partitions</b>
24 <sup>(1)</sup>	0105 82	Separation partition for 80 x 50 trunking Length 2 m
		<b>Joints</b>
20/200	0106 91	Body joint, for aligning bases during installation For cover 65 mm width
10/100	0108 01	Cover joint

Angles and end caps		
		<b>Internal and external angles</b> Include the 2 components for the top and bottom of the trunking on which the flexible cover is fitted
10/40	0106 02	Internal angle, adjustable from 80° to 100°
10/50	0106 22	External angle, adjustable from 60° to 120°

Pack	Cat.Nos	Angles and end caps (continued)
		<b>Flat angle</b>
10	0107 67	90° flat angle
		<b>End cap</b>
10/50	0107 22	Left or right end cap
		<b>Junctions</b>
10	0107 32	Flat junctions
5/25	0107 35	For specific size tap-off to 80 mm wide branch
		<b>Accessories</b>
		<b>Holding cables in place</b>
50	0106 82	Clip
		<b>VDI accessories</b>
5/50	0107 80	For internal angles
5/50	0107 81	For external angles
5/50	0107 82	For flat angles
5/50	0107 83	For flat junctions
		<b>Additional accessories</b>
5/25	0106 98	Wall crossing
40	0106 87	Capacity change
10/100	0106 88	Capacity change
5/50	0106 89	Partition junction
100/1000	0308 81	Cable tie base
20/500	0111 88	Earthing link

(1) Number of meters in pack

# DLP U-PVC adaptable trunking system and accessories 150 x 50

trunking and fittings



Selection table (p. 374-375)  
Cable carrying capacity (p. 373)

Pack	Cat.Nos	Trunking
		Suitable for a wide range of requirements and applications: - Distribution: large wiring capacity and wide access to the wiring space - Installation: can be used with various ranges of wiring accessories - Flexible cover which continuous even on angles - Adjustable internal and external angles - U-PVC trunking
		<b>Bodies</b> Supplied without cover Length 2 m
20 <sup>(1)</sup>	0104 32	150 x 50 mm
		<b>Flexible cover</b> Fits onto the whole branch including in internal or external angles
8	0105 24	Full cover width 130 mm
20	0105 22	Full cover width 85 mm
20	0105 21	Full cover width 65 mm
20	0105 20	Full cover width 40 mm Length 2 m
		<b>Partitions</b>
24 <sup>(1)</sup>	0105 82	Separation partition for 105 x 50 trunking Length 2 m
48	0104 72	Plastic clip-on partition
12	0111 06	Aluminium clip-on partition
		<b>Joints</b>
20/200	0106 91	Body joint For aligning bases during installation
10/100	0108 04	Cover joint for 130 mm width
10/100	0108 02	Cover joint for 85 mm width
10/100	0108 01	Cover joint for 65 mm width
10/100	0108 00	Cover joint for 40 mm width

Angles and end caps		
<b>Internal and external angles</b> Include the 2 components for the top and bottom of the trunking on which the flexible cover is fitted		
10/40	0106 02	Internal angle, adjustable from 80° to 100°
10/50	0106 22	External angle, adjustable from 60° to 120°

Pack	Cat.Nos	Angles and end caps (continued)
5	0107 89	<b>Flat angle</b> 90° flat angle
10/50	0107 06	<b>End cap</b> Left or right end cap
<b>Junctions</b>		
10	0107 32	Flat angles
5/25	0107 35	To tap-off to an 80 mm wide branch
5/25	0107 37	To tap-off to a 105 mm wide branch equipped with a 65 mm cover
5/25	0107 36	To a tap-off to a 105 mm wide branch equipped with a 85 mm cover
<b>Partion junction</b>		
5/50	0106 11	For internal angles
5/50	0106 32	For external angles
5/25	0107 42	For flat angles

Accessories		
<b>Holding cables in place</b>		
50	0106 86	Clip for 130 mm width cover
50	0106 82	Clip for 65 mm width cover
<b>VDI accessories</b>		
5/50	0107 80	For internal angles
5/50	0107 81	For external angles
5/50	0107 82	For flat angles
5/50	0107 83	For flat junctions

(1) Number of meters in pack

(1) Number of meters in pack

**Bold catalogue numbers** are products normally available with Legrand (India) stockists.  
**Cat. nos. that are not bold** - delivery within 4 - 8 weeks from the date of order.

**Bold packing quantity** is our mandatory packing. Orders to be placed by Legrand (India) stockists in multiples of the same.

# DLP U-PVC adaptable trunking system and accessories 195 x 50

trunking and fittings

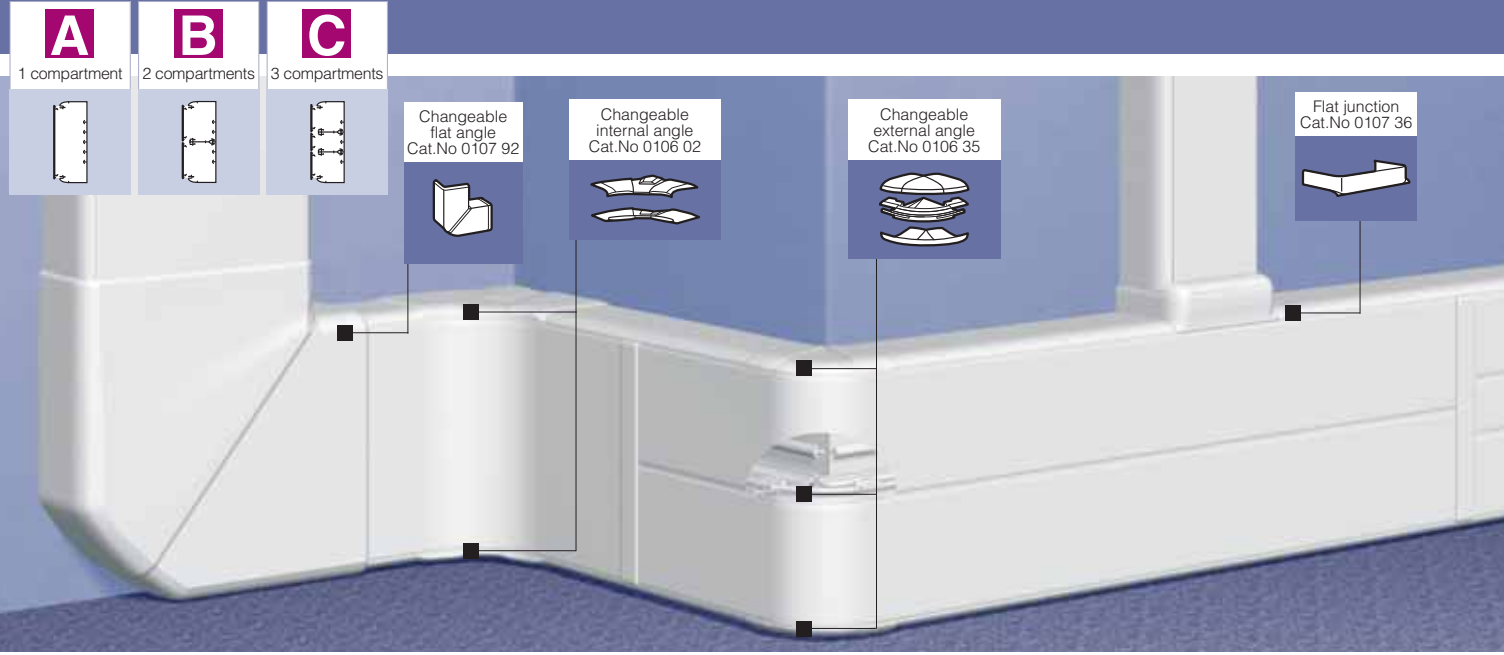

Selection table (p. 374-375)  
Cable carrying capacity (p. 373)

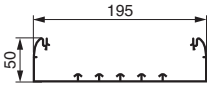
Pack	Cat.Nos	Trunking
		Suitable for a wide range of requirements and applications: - Distribution: large wiring capacity and wide access to the wiring space - Installation: can be used with various ranges of wiring accessories - Flexible cover which continuous even on angles - Adjustable internal and external angles
8	0104 52	<b>Bodies</b> Supplied without cover Length 2 m 195 x 50 mm
		
		<b>Flexible cover</b> Fits onto the whole branch including in internal or external angles
8	0105 26	Full cover width 180 mm
20	0105 22	Full cover width 85 mm
8	0105 24	Full cover width 130 mm
20	0105 21	Full cover width 65 mm
20	0105 20	Full cover width 40 mm
		Length 2 m
		<b>Partitions</b>
24 <sup>(1)</sup>	0105 82	Separation partition for 195 x 50 trunking Length 2 m
48	0104 72	Plastic clip-on partition
12	0111 06	Aluminium clip-on partition
		<b>Joints</b>
20/200	0106 91	Body joint For aligning bases during installation
10/100	0108 06	Cover joint for 180 mm width
10/100	0108 02	Cover joint for 85 mm width
10/100	0108 04	Cover joint for 130 mm width
10/100	0108 01	Cover joint for 65 mm width
10/100	0108 00	Cover joint for 40 mm width

Angles and end caps	
<b>Internal and external angles</b> Include the 2 components for the top and bottom of the trunking on which the flexible cover is fitted	
10/40	0106 02  Internal angle, adjustable from 80° to 100°
10/50	0106 22  External angle, adjustable from 60° to 120°

Pack	Cat.Nos	Angles and end caps (continued)
2	0107 92	<b>Flat angle</b> 90° flat angle
5/50	0107 07	<b>End cap</b> Left or right end cap
<b>Junctions</b>		
10	0107 32	Flat angles
5/25	0107 35	To tap-off to an 80 mm wide branch
5/25	0107 37	To tap-off to a 105 mm wide branch equipped with a 65 mm cover
5/25	0107 36	To a tap-off to a 105 mm wide branch equipped with a 85 mm cover
<b>Partion junction</b>		
5/50	0106 11	For internal angles
5/50	0106 32	For external angles
5/25	0107 42	For flat angles
<b>Accessories</b>		
<b>Holding cables in place</b>		
50	0106 86	Clip for 130 mm width cover
50	0106 82	Clip for 40 mm width cover
<b>VDI accessories</b>		
5/50	0107 80	For internal angles
5/50	0107 81	For external angles
5/50	0107 82	For flat angles
5/50	0107 83	For flat junctions

**Bold catalogue numbers** are products normally available with Legrand (India) stockists.  
**Cat. nos. that are not bold** - delivery within 4 - 8 weeks from the date of order.

**Bold packing quantity** is our mandatory packing. Orders to be placed by Legrand (India) stockists in multiples of the same.