

DPX™ 1250

MCCBs from 500 to 1250 A



0258 04

Dimensions (p. 97)
Technical data (p. 81-82)

Confirm to IEC 60947-2
Fixed version - Front terminals
Max. rated voltage 690 V A - 50/60 Hz
Thermal release adjustable from 0.8 to 1 In
Magnetic release adjustable from 5 to 10 < 1 000 A ≤ 3 to 6 In
Integrated label holder

Pack	Cat. nos.		DPX 1250
	3 P	4 P ⁽¹⁾	Breaking capacity I _{cu} : 50 kA (400 V A) In
1	0258 00	0258 07	500
1	0258 01	0258 08	630 A
1	0258 02	0258 09	800 A
1	0258 03	0258 10	1000 A
1	0258 04	0258 11	1250 A

Pack	Cat. nos.		DPX-H 1250
	3 P	4 P ⁽¹⁾	Breaking capacity I _{cu} : 70 kA (400 V ~) In
1	0258 14	0258 21	500 A
1	0258 15	0258 22	630 A
1	0258 16	0258 23	800 A
1	0258 17	0258 24	1000 A
1	0258 18	0258 25	1250 A

Pack	Cat. nos.		DPX-L 1250
	3 P	4 P ⁽¹⁾	Breaking capacity I _{cu} : 100 kA (400 V ~) In
1	0258 28	0258 37	500 A
1	0258 29	0258 38	630 A
1	0258 31	0258 40	1000 A
1	0258 32	0258 41	1250 A

DPX™ 1250

rotary handles and other accessories



0262 61



OS0262 25/3



0262 66



0262 60

Confirm to IEC 60947-2
Fixed version - Front terminals
Max. rated voltage 690 V A - 50/60 Hz
Thermal release adjustable from 0.8 to 1 In
Magnetic release adjustable from 5 to 10 < 1 000 A ≤ 3 to 6 In
Integrated label holder

Pack	Cat. nos.	Rotary handles
		Available in two versions <ul style="list-style-type: none"> • Direct on DPX • Vary-depth handle The vary-depth handle includes the connecting rod, the bracket, the self-adhesive drilling template, the mounting accessories and the door locking mechanism
1	0262 61	Direct on DPX
1	0262 83	Vary-depth handle
1	OS0262 25/3	Locking accessories for rotary handle For locking the rotary handle (Direct type only) (set of 3 locks with keys)
1	0262 66	Phase barriers Used to isolate the connections between each pole Set of 3 insulation shields
1	0262 60	Padlock support For locking the handle in "OFF" position For handle
1	0261 23	Motor For remote making and breaking of a DPX MCCB and reset in the event of tripping on a fault A lock prevents operation when working on the line. Front operated 230 V ~/=
1	0264 10	Supply inverter type Mounting plate For mechanical interlock of 2 DPX MCCBs
1	0261 93	Electronic control box For detecting the absence of voltage or a drop in voltage : triggers the opening of a power supply source Standard

⁽¹⁾ For automatic version add 2 motor operators and necessary auxiliaries

DPX™ 1600

MCCBs from 630 to 1600 A with microprocessor release



0257 08



0257 58

DPX™ 1600

rotary handles and other accessories



0262 61



OS0262 25/3



0262 66



0262 60



Dimensions (p. 98)
Technical data (p. 82-83)

Confirm to IEC 60947-2

Fixed version - Front terminals

Max. rated voltage 690 V A - 50/60 Hz

Thermal release adjustable from 0.8 to 1 In

Magnetic release adjustable from 5 to 10 < 1 000 A ≤ 3 to 6 In

Integrated label holder

Pack	Cat. nos.		Microprocessor release
			Confirm to IEC 60947-2 Fixed version - Front terminals Supplied with incoming terminals mounted
			DPX 1600
			Breaking capacity Icu : 50 kA (380/415 V AC)
			S1 - Adjustment of Ir, Im
	3 P	4 P	In
1	0257 01	0257 05	630 A
1	0257 02	0257 06	800 A
1	0257 03	0257 07	1250 A
1	0257 04	0257 08	1600 A
			Sg - Adjustment of Ir, Tr, Im, Tm, Ig, Tg
1	0257 51	0257 55	800 A
1	0257 52	0257 56	1250 A
1	0257 53	0257 57	1600 A

Pack	Cat. nos.	Rotary handles
		Available in two versions
		• Direct on DPX
		• Vary-depth handle
		The vary-depth handle includes the connecting rod, the bracket, the self-adhesive drilling template, the mounting accessories and the door locking mechanism
1	0262 61	Direct on DPX
1	0262 83	Vary-depth handle

Pack	Cat. nos.	Locking accessories for rotary handle
1	OS0262 25/3	For locking the rotary handle (set of 3 locks with keys)

Pack	Cat. nos.	Phase barriers
1	0262 66	Used to isolate the connections between each pole Set of 3 insulation shields

Pack	Cat. nos.	Padlock support
1	0262 60	For locking the handle in "OFF" position For handle

Pack	Cat. nos.	Motor
1	0261 27	For remote making and breaking of a DPX MCCB and reset in the event of tripping on a fault A lock prevents operation when working on the line. Front operated 230 V ~/∞

Pack	Cat. nos.	Supply inverter type
1	0264 10	Mounting plate Factory-assembled version only Kindly check with our sales staff for more details
1	0261 93	Electronic control box For detecting the absence of voltage or a drop in voltage : triggers the opening of a power supply source Standard

Bold catalogue numbers are products normally available with Legrand (India) stockists.
Cat. nos. that are not bold delivery within 4 - 8 weeks from the date of order.

Bold packing quantity is our mandatory packing. Orders to be placed by Legrand (India) stockists in multiples of the same.

■ **Dimensions**

Fixed version, front terminals

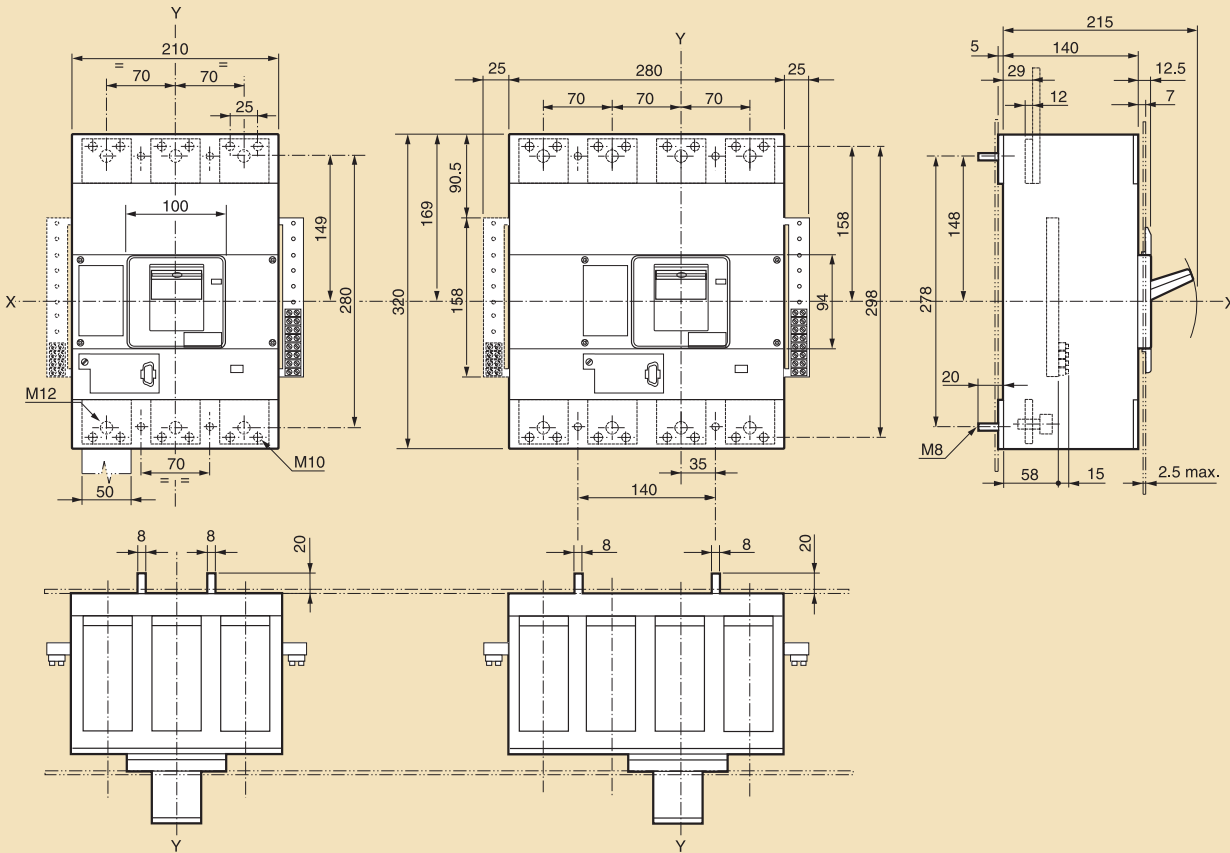

Direct on DPX rotary handles

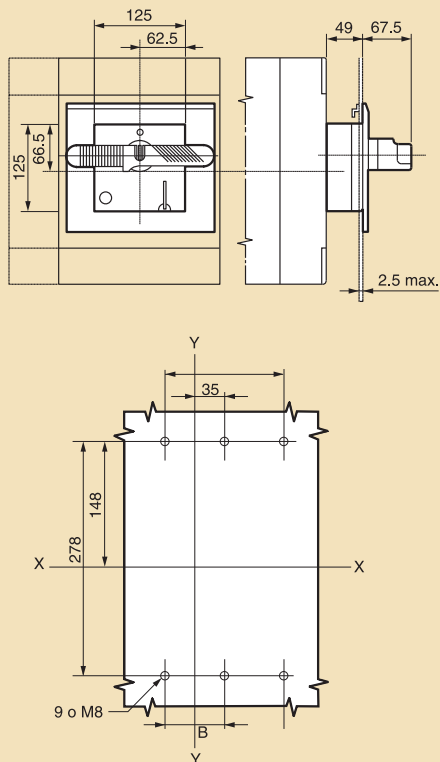

Rotary handle-vari-depth handle on door

Mounting with flexible seal

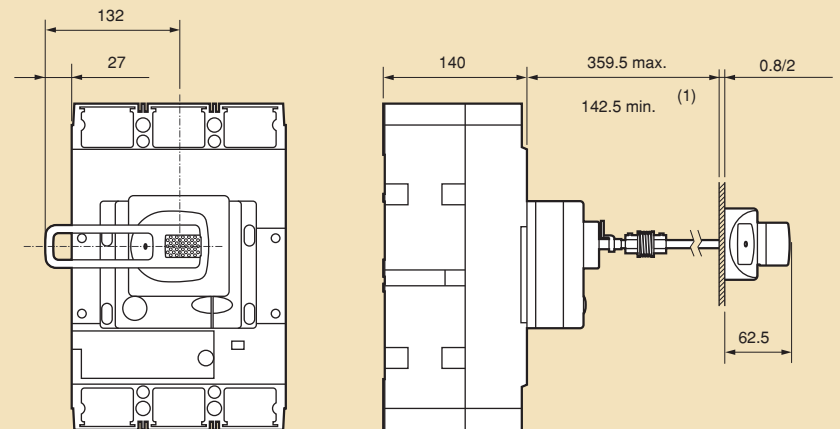

- Accessoires de montage
- Mounting accessories
- Montage-Zubehör
- Accesorios de montaje
- Accessori di montaggio

- Acessórios de montagem
- εξαρτήματα συναρμολόγησης
- Wyposażenie montażowe
- Montaj aksesuarları

DPX 1600

