

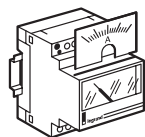

Dimensions **see e-catalogue**

Pack	Cat.Nos	Analogue metering devices	
		Ammeters	
		Measure the intensity in Amperes (A) of the current circulating in an electrical circuit	Number of modules
1	0 046 02	Direct connection AC or DC Scale: 0 - 30 A - supplied with dial	4
1	0 046 00	Connected via a 0 - 5 A output current transformer (CT)	4
		Measuring dials for ammeter Cat.No 0 046 00	
2	0 046 10	0-50 A	
2	0 046 13	0-100 A	
2	0 046 15	0-200 A	
2	0 046 16	0-250 A	
2	0 046 17	0-300 A	
2	0 046 18	0-400 A	
2	0 046 20	0-600 A	
2	0 046 21	0-800 A	
2	0 046 22	0-1000 A	
2	0 046 66	0-1250 A	
2	0 046 24	0-1500 A	
2	0 046 25	0-2000 A	
		Voltmeter	
		Measure the AC or DC voltage in a circuit in volts (V)	Number of modules
1	0 046 60	Scale: 0-500 V	4
		Digital ammeter / voltmeter	
		- Ammeter mode: connected via a 0 - 5 A current transformer (CT) Reading range adjusted according to CT used	Number of modules
1	0 046 63	- Voltmeter mode: measures the AC or DC voltage of an electrical circuit; scale 0 - 600 V Voltage: 230 V \sim - 50/60 Hz Reading: I - 0 to 8000 A U - 0 to 500 V	4



Pack	Cat.Nos	Selective measurement switches	
		For manual selection of the circuits to be measured	
		Ammeter cam switch	
		For measuring the current in a circuit with one ammeter, connected via a current transformer (CT)	Number of modules
1	0 046 50	3-phase, 4-position cam switch	3
		Voltmeter cam switches	
		For measuring the voltages in a circuit with one voltmeter	Number of modules
1	0 046 52	3-phase, 4-position cam switch	3
1	0 046 53	3-phase with neutral, 7-position cam switch	3
		Digital frequency meter	
		For measuring the frequency of a 230 V \sim electrical circuit in hertz (Hz) Supply voltage 230 V \sim (connected to circuit to be measured)	Number of modules
1	0 046 64	Green LED 3 digit display - 40-80 Hz display	4
		Totalising hour counters	
		Count the operating hours of a machine or an electrical device to determine its exact operating time Counter with numerical display Capacity: 5 digits + 2 decimal places (1 unit = 1 hour) Precision: 1/100th hour Consumption: 0.2 VA	Number of modules
1	0 046 94	230 V \sim - 50 Hz	2
1	0 046 91	24 V \sim - 50 Hz	2



Electrical energy metering on door



0 146 00 + 0 146 16



0 146 61



0 495 55

Ammeters, voltmeters, totalising, can be mounted on XL³ 800 and XL³ 4000 curved doors

Pack Cat.Nos Analogue metering devices

Pack	Cat.Nos	Analogue metering devices
		Ammeters
		Measure the intensity in amperes (A) of the current Connected via a 0 - 5 A output current transformer (CT)
		To be fitted with a measuring dial appropriate for the current to be measured
1	0 146 00	Round barrel Ø56 mm
1	0 146 01	Square barrel 68 x 68 mm
		Measuring dial for ammeters
		Supplied by set of 2 (1 for round barrel, 1 for square barrel)
1	0 146 10	0 - 50 A
1	0 146 13	0 - 100 A
1	0 146 15	0 - 200 A
1	0 146 16	0 - 250 A
1	0 146 17	0 - 300 A
1	0 146 18	0 - 400 A
1	0 146 20	0 - 600 A
1	0 146 21	0 - 800 A
1	0 146 22	0 - 1000 A
1	0 146 66	0 - 1250 A
1	0 146 24	0 - 1500 A
1	0 146 25	0 - 2000 A
1	0 146 26	0 - 2500 A
1	0 146 28	0 - 4000 A
		Voltmeters
		Measure the voltage in volts (V) AC ou DC
		Scale: 0 - 500 V
1	0 146 60	Round barrel Ø56 mm
1	0 146 61	Square barrel 68 x 68 mm

Totalising hour counters (48 x 48)

Pack	Cat.Nos	Totalising hour counters (48 x 48)
		One-piece device - IP 40
		Front mounting on enclosure or cabinet doors
		Synchronous motor operation (operation indicator)
		For counting the operating hours of an electrical machine or device, with no reset
		Supplied with cover frame (55 x 55 mm) (for round cut-out) and fixing accessories
		Connection: 2 x 1.5 mm ²
1	0 495 52	24 V~ - 50 Hz
1	0 495 53	110 to 120 V~ - 50 Hz
1	0 495 54	110 to 120 V~ - 60 Hz
1	0 495 55	200 to 240 V~ - 50 Hz
1	0 495 58	48 V~ - 50 Hz
1	0 495 59	400 V~ - 50 Hz
1	0 495 60	12 to 36 V _{DC}
100	0 495 97	Frame 55 x 55 mm

Electrical energy metering

Metering devices on rail

Technical characteristics

Analogue ammeters

Type of measurement	Analogue	
	Ferromagnetic	
Frequency	50 to 60 Hz	
Precision	1.5 %	
Operating temperature	- 10 °C to + 40 °C	
Storage temperature	- 20 °C to + 80 °C	
Consumption:		
• voltage circuit	-	
• measurement circuit	1.1 VA	
Connection capacity	Direct	Par TI
	6 mm ²	4 mm ²
Conformity to standards	NF EN 61010-1	

Analogue Voltmeters

Type of measurement	Analogue	
	Ferromagnetic integration	
Frequency	50 to 60 Hz	
Precision	1.5 %	
Operating temperature	- 10 °C to + 40 °C	
Storage temperature	- 20 °C to + 80 °C	
Consumption	3 VA	
Connection capacity	2 x 2.5 mm ²	
Conformity to standards	NF EN 61010-1	

Digital frequency meter

Type of measurement	Quartz electronic
Precision	± 0.2 % for ± 1 digit
Operating temperature	- 10 °C to + 40 °C
Storage temperature	- 20 °C to + 70 °C
Consumption	4.5 VA
Connection capacity	2 x 2.5 mm ²
Conformity to standards	NF EN 61010-1

Analogue metering devices on door

Technical characteristics

Frequency: 50/60 Hz
 Precision class: 1.5 %
 Operating temperature: - 10 °C to + 40 °C
 Storage temperature: - 20 °C to + 80 °C
 Consumption:
 - ammeter: 1.1 VA
 - voltmeter: 3 VA
 Connection capacity: 2 x 2.5 mm² with screws or
 Conform to IEC 60051, VDE 0410, BS 89,
 EN 60051-1, cenelec HD 223

Dimensions

Cat.Nos 0 146 01/61

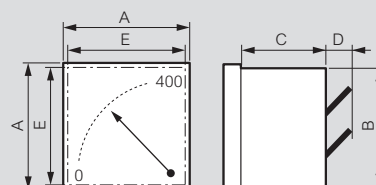

Dimensions (mm)				
A	B	C	D	E
72	66.5	44	12	68±0,7

Cat.Nos 0 146 00/60

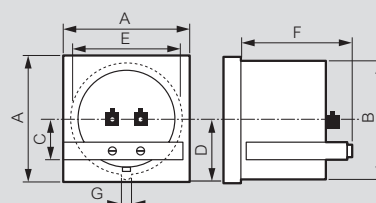

Dimensions (mm)						
A	B	C	D	E	F	G
72	Ø55	21.4	28.5	56	46	3.2