

Arteor™ power units and power strips prewired



5735 42

Arteor™ television and telephone sockets



5734 25

5734 27

Technical data (p. 250)

Cover plates selection chart (p. 262-265)
Technical data (p. 257)

Pack	Cat.Nos		Power units
1/5	White	Magnesium	16 A, AC and Geyser White version supplied with support frame and White plate, Magnesium version supplied without support frame, to be equipped with 4-module plate 4 modules 90 x 45 mm
	5735 42	5737 42	
1/5	5721 54	5726 54	32 A, AC and Geyser, with cable output

Pack	Cat.Nos		Television sockets
20/200	White	Magnesium	TV sockets TV single Co-Axial socket (Ø9.52 mm female) 0-860 MHz 1 module 22.5 x 45 mm
	5734 25	5736 25	
20/200	White	Magnesium	RJ 11 sockets Equipped with modular Jack connector with 1/4 turn terminal for fast connection (possible looping)
	5734 26	5736 26	
20/200	5734 27	5736 27	RJ 11 Single RJ11 with label holder 1 module 22.5 x 45 mm Double RJ11 1 module 22.5 x 45 mm

Pack	Cat.Nos		Power strips prewired
1/10	White	Magnesium	Set of 3 multistandard sockets with one pre-wired 20 A, 1-way switch with indicator White version supplied with support frame and White plate, Magnesium version supplied without support frame, to be equipped with 8-module plate
	5737 80	5739 80	

Pack	Cat.Nos		Energy plugs
1/10/100	White	Magnesium	6A Plug 16A Plug 25A Plug
1/10/100	5738 86	5738 87	
1/10/100	5738 88	5738 89	
1/10/100	5738 07	5738 90	

Arteor™

television and telephone sockets

Arteor™

RJ 45

■ Technical data

Television sockets

Cat. no. 5734 25 / 5736 25

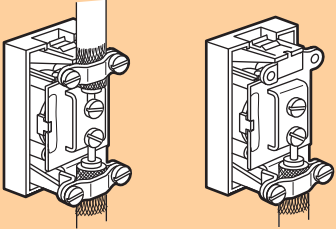

RJ 11

Cat. no. 5734 26 / 5736 26

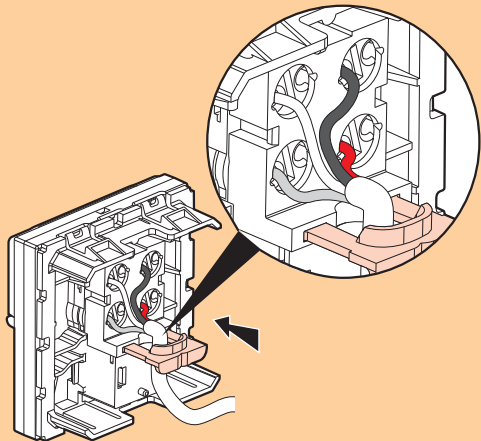
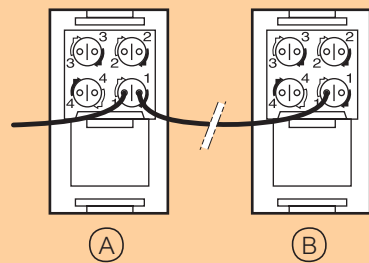
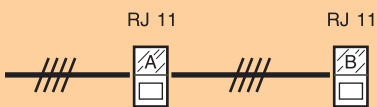
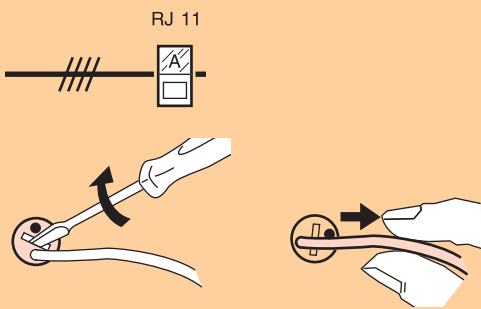

■ Technical data

RJ 45

Cat. no. 5734 29 / 28 / 5736 29 / 28

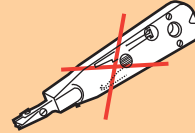
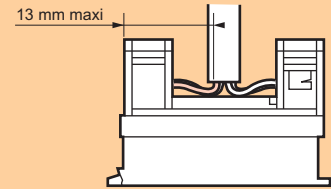
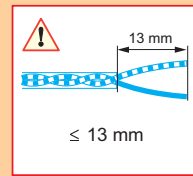

U/UTP

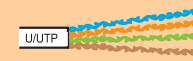
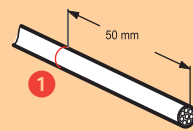

F/UTP

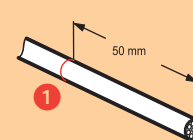

SF/UTP

