

**Myrius™**  
access control - white  
hospitality functions

**Myrius™**  
sockets and connectors - white



6730 37



6730 40



6730 50



6730 51



6730 52



6730 53



6730 56

*Technical data (p. 328)*

Pack	Cat. nos.	Key fob switch
1/10	<b>6730 37</b>	15 A key fob switch with timedelay 30 sec. supplied without key fob. cat. no. 6730 38
1/10/100	<b>6730 38</b>	Only key fob for switch above

Pack	Cat. nos.	"Do not disturb" indicator and internal control unit
10/100	<b>6730 39</b>	Enables the clients to inform hotel staff of the room status Two settings: • Do not disturb • Clean the room <b>indicator (external unit)</b> to be installed on the corridor, displays the status supply with lamps
10/100	<b>6730 40</b>	<b>"DND control unit" (internal unit)</b> Allows the user to select choose the options supplied with lamps

Pack	Cat. nos.	Shaver socket
1/5/20	<b>6730 49</b>	Accept European, British, American and Australian 2 pin plugs In-built thermal protection, disconnects supply above 20 VA Supplied complete with screw caps with inbuilt IP24 protection transformer enhancing safety. Fits on 4 module Flush box 220/240 V - 50/60 Hz

*Technical data (p. 329-334)*

Number of modules	Pack	Cat. nos.	TV socket	Number of modules
Monobloc with plate	20/200	<b>6730 50</b>	TV socket	1
	10/100	<b>6730 51</b>	TV / Sat / FM 6 shielded socket 0 - 2400 MHz	2

Number of modules	Pack	Cat. nos.	Data & voice	Number of modules
1+1	20/200	<b>6730 52</b>	RJ-11 Telephone socket with transparent shutter	1
	20/200	<b>6730 53</b>	RJ-11 Double telephone Socket with shutter	1
	20/200	<b>6730 54</b>	UTP Cat 5e information outlets toolless system	1
	20/200	<b>6730 55</b>	UTP Cat 6	1
	10/100	<b>6730 56</b>	UTP Cat 6	2

Number of modules  
Monobloc with plate

**NEW**

**Myrius™**  
access control - black  
hospitality functions

**Myrius™**  
sockets and connectors - black



6731 40



6731 50



6731 51

**Technical data (p. 328)**

**Technical data (p. 329-334)**

Pack	Cat. nos.	<b>Key fob switch</b>
1/10	6731 37	<p>15 A key fob switch with timedelay 30 sec. supplied without key fob. cat. no. 6731 38 Only key fob for switch above</p>
1/10	6730 38	

Number of modules  
Monobloc with plate

10/100	6731 39	<p><b>"Do not disturb" indicator and internal control unit</b> Enables the clients to inform hotel staff of the room status Two settings: • Do not disturb • Clean the room</p> <p><b>Indicator (external unit)</b> to be installed on the corridor, displays the status supply with lamps</p>
10/100	6731 40	<p><b>"DND control unit" (internal unit)</b> Allow the user to select choose the options supplied with lamps</p>

Number of modules

1+1

1+1

Pack	Cat. nos.	<b>Shaver socket</b>
1/5/20	6731 49	<p>Accept European, British, American and Australian 2 pin plugs In-built thermal protection, disconnects supply above 20 VA Supplied complete with screw caps with inbuilt IP24 protection transformer enhancing safety. Fits on 4 module Flush box</p> <p>220/240 V - 50/60 Hz</p>

Number of modules  
Monobloc with plate

Pack	Cat. nos.	<b>TV socket</b>	Number of modules
20/200	6731 50	<p>TV Socket</p>	1
10/100	6731 51	<p>TV / Sat / FM shielded sockets 0 - 2400 MHz</p>	2

# Myrius™ buzzer

# Myrius™ infrared sensor - 300W

## ■ Technical data

### Buzzer

Cat. no. 6730 38 / 39, 6731 39 / 40, 6730 34 / 6731 34

### Description

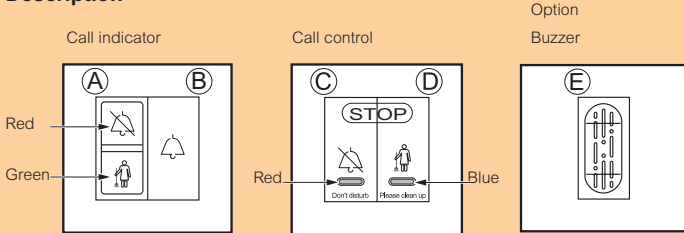

### Wiring

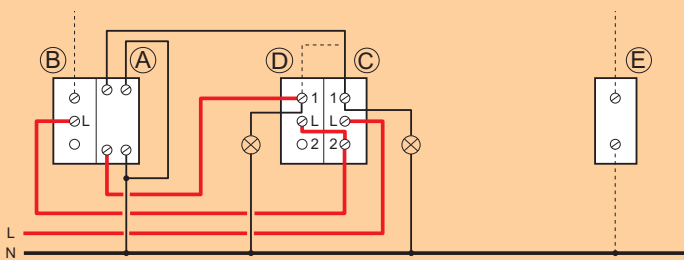

### Operation

#### 1- Instruction : «Do not disturb»

Bedroom

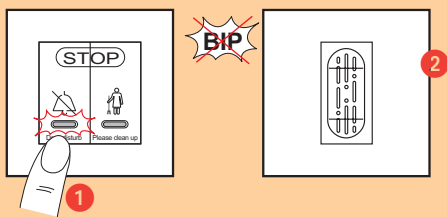

Corridor

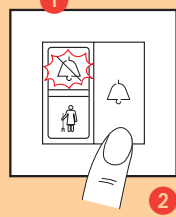

#### 2- Instruction : «Please clean up»

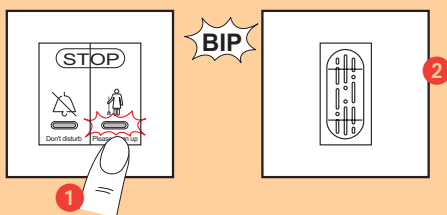

#### 3- No call

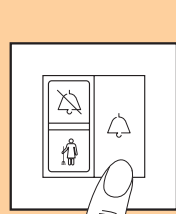
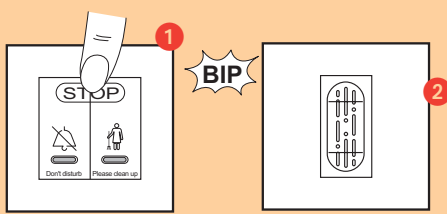

**Note :** If both buttons are pressed simultaneously, priority is given to the «don't disturb» call

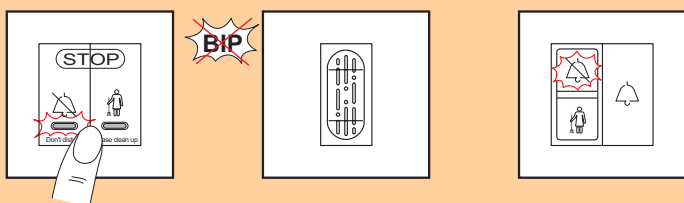

## ■ Technical data

### Automatic switch

Cat. no. 6730 32 - 6731 32

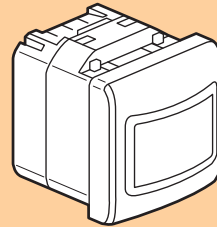

Temperature 35° 0° 100 - 240 Vac 50Hz	Cable cross-section 1 x 2.5 mm <sup>2</sup> 2 x 2.5 mm <sup>2</sup>	Lighting options			
		Incandescent	LED	LED + Transformer	LED + Transformer (*)
240 Vac	Max.	400 W	400 W	400 W	400 W
	Min.	40 W	40 W	40 W	40 W
100 Vac	Max.	200 W	200 W	200 W	200 W
	Min.	40 W	40 W	40 W	40 W

(\*) Use only transformers which are intended for use with an electronic switch.

### Mounting with a switch

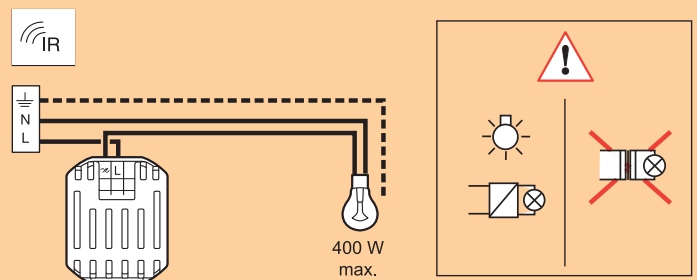

### Mounting with offset push button

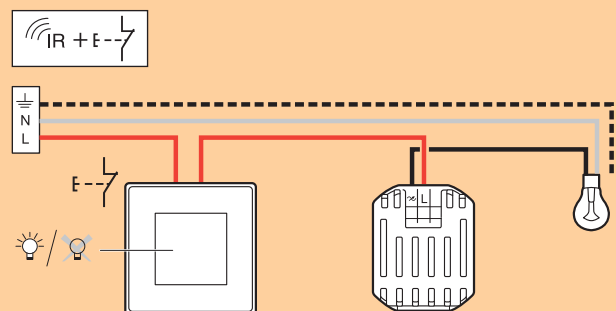

### Mounting with a several combined switch

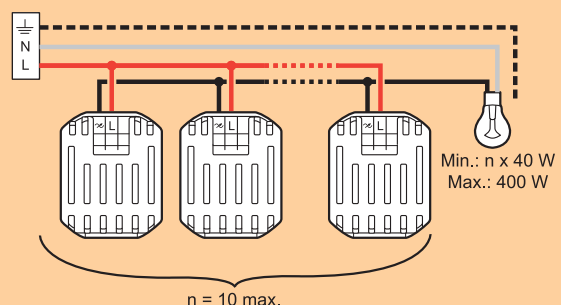

**Myrius™**  
key fob switch

■ **Technical data**

**Key fob switch**

Cat. no. 6730 37 - 6731 37

**Wiring diagram of key fob switch**

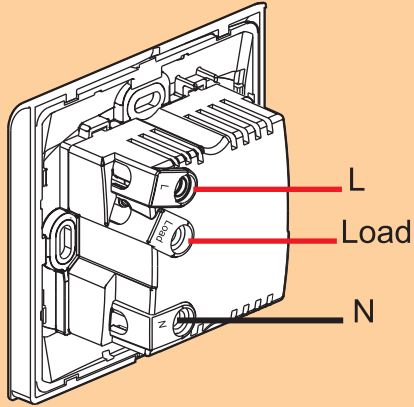

**Operation**

Inserting card turns power on  
Removing card turns power off after an approx. 30s delay

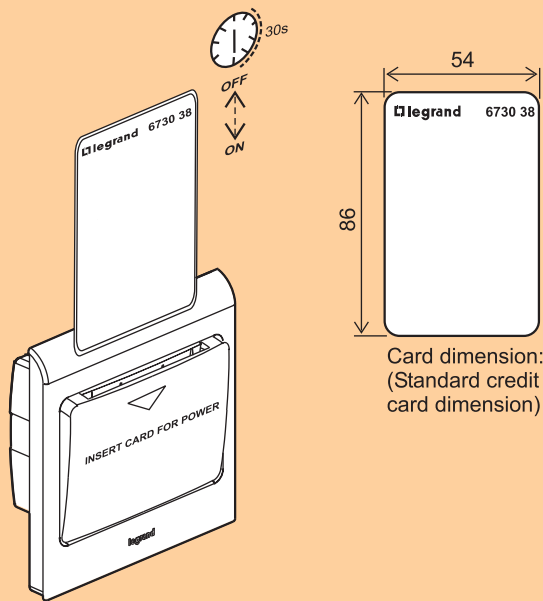

**Disassembly**

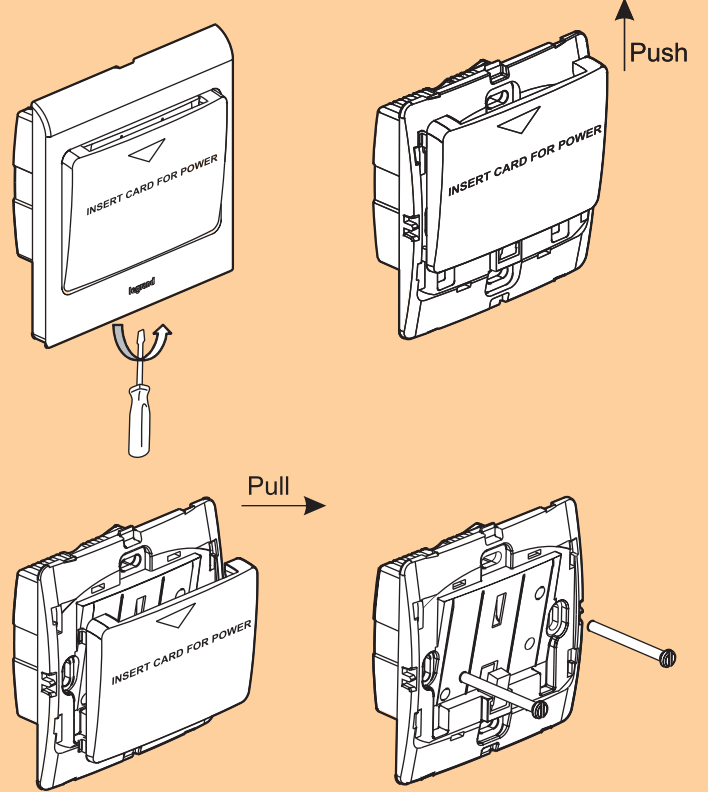

**Characteristics**

	15A max
	15A / 230V~ $\mu \cos \phi = 1$
	4A / 230V~ $\mu \cos \phi = 0.6$

**Utilization**

	①	②	③	④
25°C 230 V 50 Hz			Ø26 Ø38	Ø26 Ø38
Max.	1800 W	800 W	400 VA	800 VA

1. 1800W incandescent or halogen with ferromagnetic transformer
2. 800W inductive (motor)
3. 400VA compensated fluorescent
4. 800VA fluorescent with electronic ballast

**Important**

For load higher than indicated in the above table, use a contactor.

## Myline™ mechanisms

switches and accessories



Switches are ISI marked as per the latest IS 3854:1997  
Silver plated screw terminals  
Linc-Loc™ Inter locking mechanisms for perfect alignment.  
Laser marking.

Pack	Cat. nos.	Switches	Number of modules
		<b>6 A - *230V ~</b>	
20/200	<b>6755 01</b>	6 A one-way SP switch	1
20/200	<b>6755 02</b>	6 A two-way SP switch	1
20/200	<b>6755 03</b>	6 A one-way SP switch with indicator	1
		<b>16 A - *230V ~</b>	
20/200	6755 11	16 A one-way SP switch	1
20/200	6755 12	16 A two-way SP switch	1
20/200	6755 13	16 A one-way SP switch with indicator	1
		<b>Switches 32 A - *230V ~</b>	
10/100	6755 26	32 A one-way double pole switch with indicator	2
		<b>Push Buttons 6 A - *230V ~</b>	
20/200	<b>6755 04</b>	6 A one-way SP bell push	1
10/100	6755 06	6 A one-way SP bell push with indicator	2
		<b>Bell Call Indicator &amp; Register</b>	
20/200	6755 07	Bell call Indicator with register - 6 A	1
		<b>Lighting Modules</b> for night Lamp... neon light for 25000 hrs.	
20/200	6755 95	Indicator Light red	1
20/200	6755 96	Indicator Light orange	1
1/5/25	<b>6755 97</b>	Skirting light with white LED	3

Note for 230 volt AC from Mosaic pages

## Myline™ mechanisms

dimmers and fan regulators



Conforming to IS 11037

Pack	Cat. nos.	Dimmers and fan regulators	Number of modules
		<b>Dimmer with off and gradual dimming</b>	
1/10/100	6755 30	Fan regulator 100 W, Humfree, 0-4 steps	2
1/5/50	<b>6755 31</b>	For regulator 100W, Humfree, 0-4 step	1
1/10/100	6755 35	Rotative dimmer 60-250 W for light	2
1/5/50	6755 33	Rotative dimmer 60 - 400W	1
		<b>Buzzer</b>	
20/200	6755 40	Buzzer	1
		<b>DND &amp; MMR</b>	
		<b>Indicator lamp</b>	
10/50	6755 56	DND & MMR external unit bell push	1+1+1
10/100	6755 57	Myline internal control unit for DND & MMR	2
		<b>Key Fob</b>	
1/10	6755 60	Key fob switch	M
1	6730 38	Only key fob for switch above	

**Bold catalogue numbers** are products normally available with Legrand (India) stockists.  
**Cat. nos. that are not bold** - delivery within 4 - 8 weeks from the date of order.

**Bold packing quantity** is our mandatory packing. Orders to be placed by Legrand (India) stockists in multiples of the same.