



MWF331m

Compact, sturdy general-purpose floodlight with integral gear, suitable for use with high pressure tubular Sodium Vapour SON-T 250W / 400W, high pressure Metal Halide HPI-T 250W / 400W lamp. All-weather construction designed for simple cleaning and speedy servicing.

Features

- Housing made of non corrosive, high pressure die-cast aluminium with low copper content and black powder coated finish.
- Ingress protection of IP 65.
- All electrical accessories such as ballast, ignitor and power factor improvement capacitor are prewired up to terminal block.
- High grade symmetrical and asymmetrical peened anodized aluminium reflector to suite various applications.
- Wall, ceiling and surface mounting with various adjustments suitable for up / down lighting.
- Quick and easy access to lamp and gear through hinged front window with quick release stainless steel clips.
- Heat resistant EPR gasket offers sustained IP rating of IP 65.

Application

- Bill boards
- Car parks
- Architectural lighting
- Sports lighting Industrial areas
- Security lighting

Related products



MWF331m

Dimensional drawing

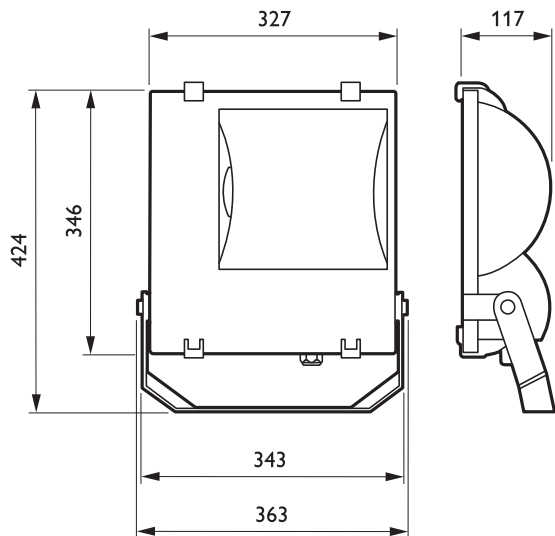

MWF331

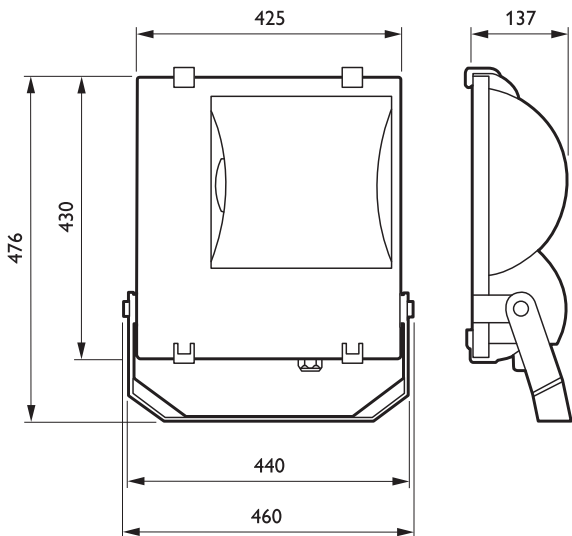

SWF331

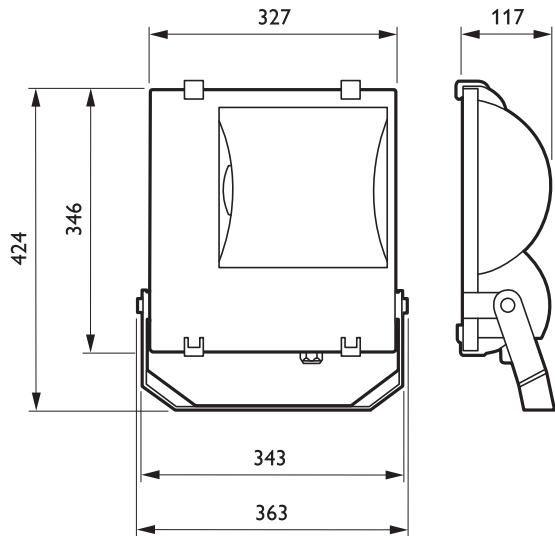

MWF331

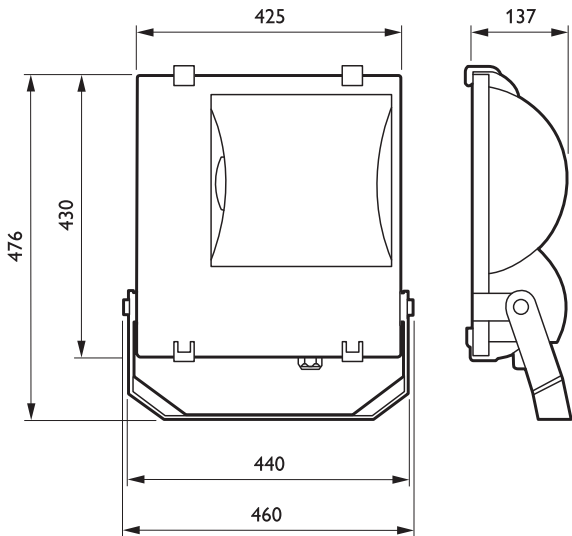

SWF331

General information

Order code	Product family code	Number of lamps	Lamp family code	Lamp power	Optic
919115810043	SWF331	1	SON-T	250	S
919115810044	MWF331	1	HPI-TP	250	S
919115810045	SWF331	1	SON-T	250	A
919115810046	MWF331	1	HPI-TP	250	A
919115810047	SWF331	1	SON-T	400	S

Order code	Product family code	Number of lamps	Lamp family code	Lamp power	Optic
919115810048	MWF331	1	HPI-TP	400	S
919115810049	SWF331	1	SON-T	400	A
919115810050	MWF331	1	HPI-TP	400	A



© 2011 Koninklijke Philips Electronics N.V.
All rights reserved.

Specifications are subject to change without notice. Trademarks are the property of Koninklijke Philips Electronics N.V. or their respective owners.

www.philips.com/lighting

2011, November 3
data subject to change