



EcoAccent ST271T

ST271T LED20/850 PSU-E MB 1C BK

EcoAccent is the LED solution for shop targeting energy savings. With a system efficacy of 95 lm/W in average, delivering more than 40% energy efficient compared to CDM solution. EcoAccent helps save energy and at the same time provides excellent lighting for retail environment thus enhancing the retail experience. The option of different light distribution for Accent light and variety of lumen packs and colour temperatures makes it an ideal solution for retail lighting.

Product data

General Information	
Light source color	850 neutral white
Driver included	Yes
Luminaire light beam spread	24°
Control interface	-
Protection class IEC	Safety class II (II)
Material	Aluminum
Operating and Electrical	
Input Voltage	240 V
Input Frequency	50 Hz
Power Factor (Min)	0.9
Controls and Dimming	
Dimmable	No
Mechanical and Housing	
Housing Material	Aluminum die-cast
Overall width	163 mm
Overall height	225 mm
Overall diameter	85 mm

Color	Black
Approval and Application	
Ingress protection code	IP20 [Finger-protected]
Mech. impact protection code	IK02 [0.2 J standard]
Surge Protection (Common/Differential)	2.5 kV
Initial Performance (IEC Compliant)	
Init. Corr. Color Temperature	5000 K
Init. Color Rendering Index	>80
Initial input power	22 W
Power consumption tolerance	+/-10%
Over Time Performance (IEC Compliant)	
Median useful life L70B50	30000 h
Application Conditions	
Ambient temperature range	0 to +45 °C
Product Data	
Order product name	ST271T LED20/850 PSU-E MB 1C BK

EcoAccent ST271T

Order code	919515810932
Numerator - Quantity Per Pack	1
Numerator - Packs per outer box	1
Material Nr. (12NC)	919515810932

Net Weight (Piece)	0.750 kg
--------------------	----------



Warnings and Safety

Dimensional drawing

Product: XRA TRACK MOUNTED
Type: ST271 T
Application: Indoor

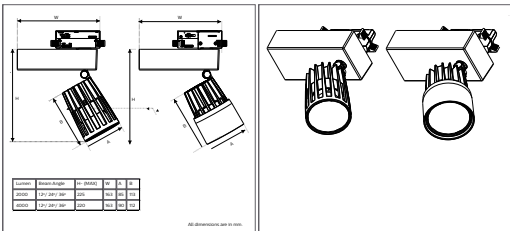

IN9002RDL - Downlights and spots

