

Surge suppressor, RC element, 127 ... 240 V AC 150 ... 250 V DC for contactor relays and motor contactors Size S00



| General technical data: | | |
|--|----|------------------|
| Product brand name | | SIRIUS |
| Product designation | | surge suppressor |
| Size of contactor | | S00 |
| Design of the surge suppressor | | with RC elements |
| Ambient temperature | | |
| <ul style="list-style-type: none"> during storage | °C | -40 ... +80 |
| <ul style="list-style-type: none"> during operation | °C | -25 ... +60 |

| Control circuit/ Control: | | |
|---|----|-------|
| Type of voltage of the control supply voltage | | AC/DC |
| Control supply voltage frequency | | |
| <ul style="list-style-type: none"> 1 rated value | Hz | 50 |
| <ul style="list-style-type: none"> 2 rated value | Hz | 60 |
| Control supply voltage 1 | | |
| <ul style="list-style-type: none"> at DC | | |
| <ul style="list-style-type: none"> <ul style="list-style-type: none"> Initial rated value | V | 150 |
| <ul style="list-style-type: none"> <ul style="list-style-type: none"> Final rated value | V | 250 |
| <ul style="list-style-type: none"> at AC | | |

| | | |
|--------------------------------|---|-----|
| — at 50 Hz Initial rated value | V | 127 |
| — at 50 Hz Final rated value | V | 240 |
| — at 60 Hz Final rated value | V | 240 |
| — at 60 Hz Initial rated value | V | 127 |

Installation/ mounting/ dimensions:

| | | |
|-------------------|----|---------|
| Mounting position | | any |
| Mounting type | | clip-on |
| Width | mm | 28 |
| Height | mm | 46 |
| Depth | mm | 9 |

Certificates/ approvals:

| | | |
|----------------------------|---------------------|--|
| Certificate of suitability | CE / UL / CSA / CCC | |
|----------------------------|---------------------|--|

| | | |
|--------------------------|---------------------------|-------------------|
| General Product Approval | Declaration of Conformity | Test Certificates |
|--------------------------|---------------------------|-------------------|



CSA



UR



EG-Konf.

[Special Test Certificate](#)

[Type Test Certificates/Test Report](#)

Shipping Approval



ABS



BUREAU VERITAS



GL



LRS



PRS



RINA

| | | |
|-------------------|-------|---------|
| Shipping Approval | other | Railway |
|-------------------|-------|---------|



RMRS

[Confirmation](#)



VDE

[Vibration and Shock](#)

Further information

Information- and Downloadcenter (Catalogs, Brochures,...)

<http://www.siemens.com/industrial-controls/catalogs>

Industry Mall (Online ordering system)

<http://www.siemens.com/industrymall>

Cax online generator

<http://support.automation.siemens.com/WW/CAXorder/default.aspx?lang=en&mlfb=3RT2916-1CD00>

Service&Support (Manuals, Certificates, Characteristics, FAQs,...)

<https://support.industry.siemens.com/cs/ww/en/ps/3RT2916-1CD00>

Image database (product images, 2D dimension drawings, 3D models, device circuit diagrams, EPLAN macros, ...)

http://www.automation.siemens.com/bilddb/cax_de.aspx?mlfb=3RT2916-1CD00&lang=en

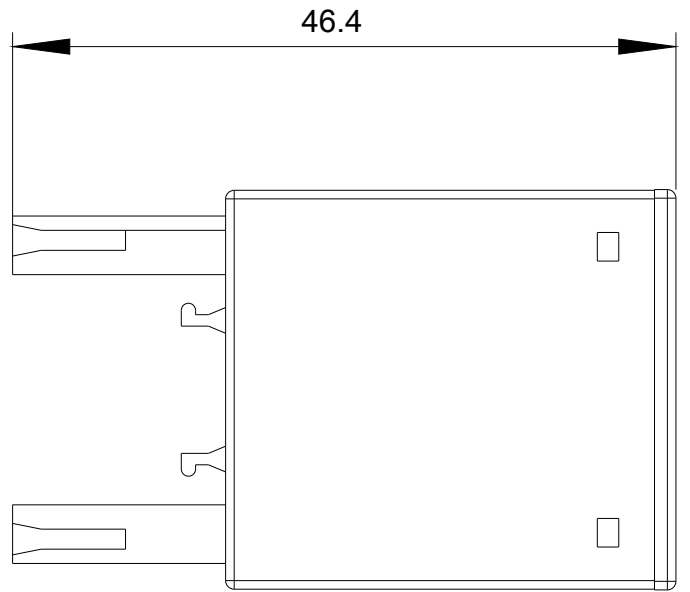
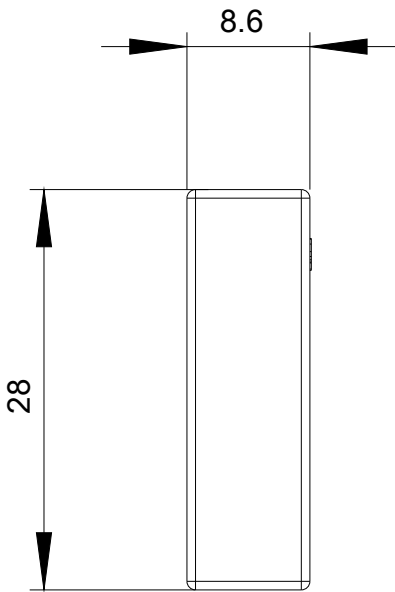



last modified:

07/25/2018