

GreenBay Gen-II

Specification	Luminaire Details
Lumen output (fixture level)	7200, 11000 and 14500 Lumens at system level
Light Source	LED Module
Beam Angle	Symmetric 60 Degree narrow beam, Symmetric 110 Degree wide beam, Symmetric and Asymmetric for petrol bunk application
System Efficacy	>100 lumens/watt
Power consumption	70, 105 and 140 W
Voltage Range	120 – 277 V AC
Lifetime	50,000 hours @ L70
Bottom Cover	High efficiency glass.
Ingress Protection	IP65
Beam	Specially designed peanut lens optics for each LED.
Weight	7.8 Kg Approx.
Material	High Pressure die-casting aluminum housing.
Light Color	5700 degree Kelvin
Driver Efficiency	➤ 85%
Surge Protection	3 KV
Power Factor	>0.95
Mounting Details	Eye Bolt.
Total Harmonic Distortion (THD)	<=20%

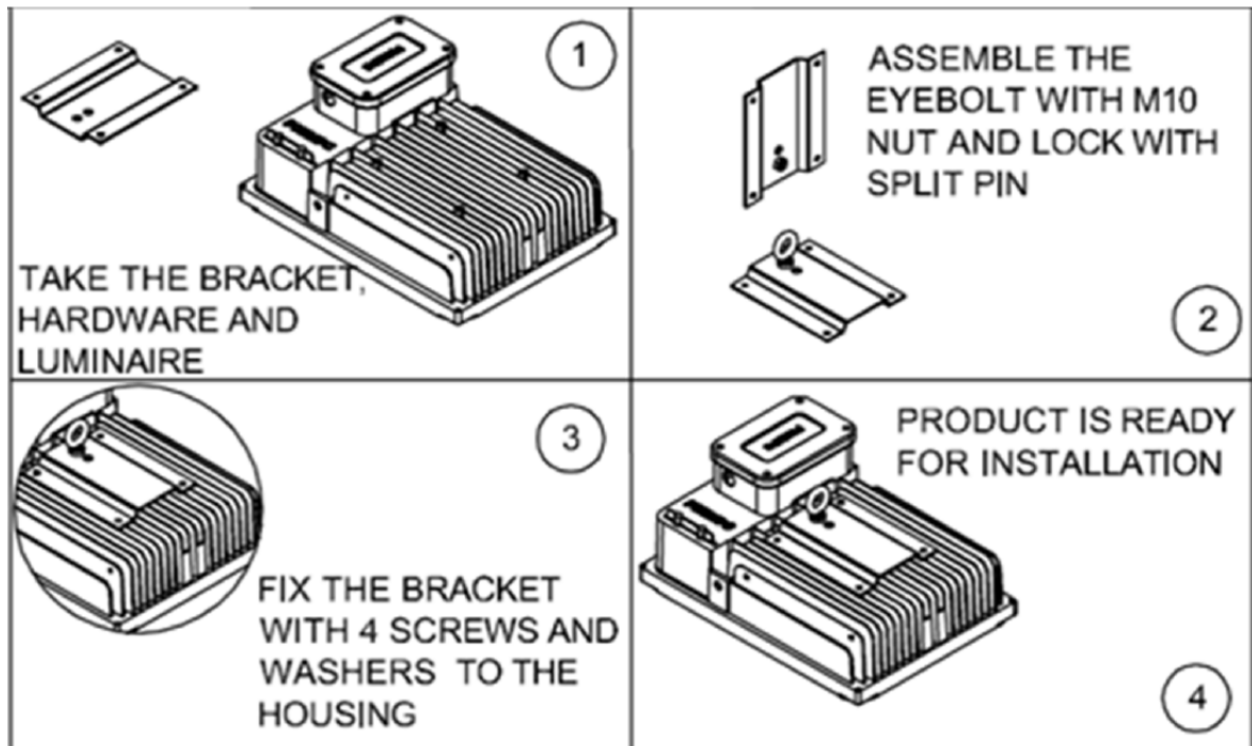

Catalogue No.	Lumen Package	Bottom Cover	Wattage
BY400V LED72S CW SK PSU S2 FG WH	7200 Lumens	High Efficiency Glass	70 W
BY400V LED72S CW SY60 PSU S2 FG WH	7200 Lumens	High Efficiency Glass	70 W
BY400V LED72S CW AK PSU S2 FG WH	7200 Lumens	High Efficiency Glass	70 W
BY400V LED72S CW SY110 PSU S2 FG WH	7200 Lumens	High Efficiency Glass	70 W
BY400V LED110S CW SK PSU S2 FG WH	11000 Lumens	High Efficiency Glass	105 W
BY400V LED110S CW AK PSU S2 FG WH	11000 Lumens	High Efficiency Glass	105 W
BY400V LED110S CW SY60 PSU S2 FG WH	11000 Lumens	High Efficiency Glass	105 W
BY400V LED110S CW SY110 PSU S2 FG WH	11000 Lumens	High Efficiency Glass	105 W
BY400V LED145S CW SK PSU S2 FG WH	14500 Lumens	High Efficiency Glass	140 W
BY400V LED145S CW AK PSU S2 FG WH	14500 Lumens	High Efficiency Glass	140 W
BY400V LED145S CW SY60 PSU S2 FG WH	14500 Lumens	High Efficiency Glass	140 W
BY400V LED145S CW SY110 PSU S2 FG WH	14500 Lumens	High Efficiency Glass	140 W



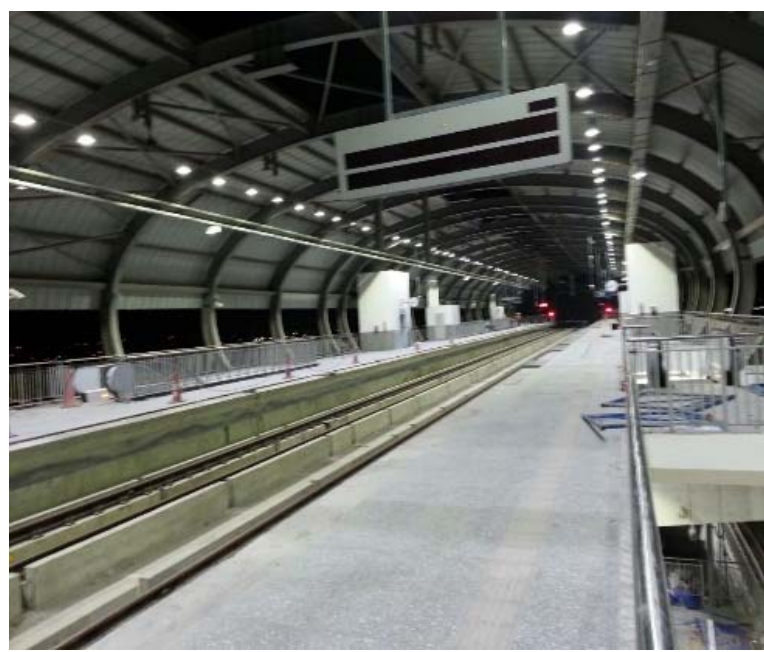

Hyderabad Metro Rail Limited



IOCL

