

Circuit breaker VL400H High switching capacity  $I_{cu}=70$  kA, 415V AC  
3-pole, non-automatic air circuit breaker Overcurrent release  
magnetic  $I_n=400$  A, Rated current  $I_l=4000$  A, Short-circuit protection

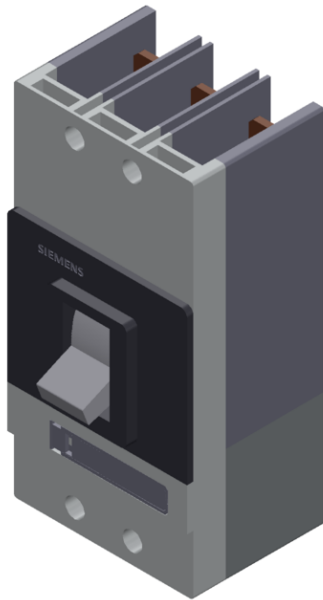

Model	
Type of the driving mechanism / motor drive	No
Design of the overcurrent release	M

General technical data	
Number of poles	3
Size of the circuit-breaker	3VL4
Electrical endurance (switching cycles) / typical	10 000
Usage category	A
Performance class for circuit breaker	N
Mechanical service life (switching cycles) / typical	20 000
Reference code / acc. to DIN 40719 extended according to IEC 204-2 / acc. to IEC 750	Q
Operating frequency / maximum	120 1/s

Voltage	
Rated operational voltage U <sub>e</sub> / max.	690 V
Insulation voltage	
• rated value	800 V
• at AC / rated value	800 V
Surge voltage resistance / rated value	8 kV

Protection class	
Protection class IP	IP20
Protective function of the overcurrent release	I

Electricity	
Operating current / at 45 °C / rated value	400 A
Continuous current / rated value	400 A
Derating temperature / for the rated value of the continuous current	50 °C
Adjustable pick-up value current	
• of instantaneous short-circuit trip unit / initial value	4 000 A
• of instantaneous short-circuit trip unit / Full-scale value	4 000 A

Main circuit	
Operating frequency	
• 1 / rated value	50 Hz
• 2 / rated value	60 Hz
Operating voltage	
• rated value / maximum	690 V
• for main current circuit / at AC / at 50 Hz / maximum	690 V

<ul style="list-style-type: none"> <li>• for main current circuit / at AC / at 60 Hz / maximum</li> </ul>	690 V
<ul style="list-style-type: none"> <li>• for main current circuit / at DC / maximum</li> </ul>	500 V
Operating current	
<ul style="list-style-type: none"> <li>• at 40 °C / rated value</li> </ul>	400 A
<ul style="list-style-type: none"> <li>• at 50 °C / rated value</li> </ul>	400 A
<ul style="list-style-type: none"> <li>• at 55 °C / rated value</li> </ul>	372 A
<ul style="list-style-type: none"> <li>• at 60 °C / rated value</li> </ul>	372 A
<ul style="list-style-type: none"> <li>• at 65 °C / rated value</li> </ul>	344 A
<ul style="list-style-type: none"> <li>• at 70 °C / rated value</li> </ul>	344 A

### Auxiliary circuit

Number of CO contacts / for auxiliary contacts	0
Number of NC contacts / for auxiliary contacts	0
Number of NO contacts / for auxiliary contacts	0

### Suitability

Suitability for use	non-automatic circuit-breakers
---------------------	--------------------------------

### Product details

Product component	
<ul style="list-style-type: none"> <li>• Trip indicator</li> </ul>	No
<ul style="list-style-type: none"> <li>• Auxiliary switch</li> </ul>	No
<ul style="list-style-type: none"> <li>• Voltage trigger</li> </ul>	No
<ul style="list-style-type: none"> <li>• undervoltage release</li> </ul>	No
<ul style="list-style-type: none"> <li>• undervoltage release with leading contact</li> </ul>	No
Product extension / optional / motor drive	Yes

### Product function

Product function	
<ul style="list-style-type: none"> <li>• of thermal overload trip unit</li> </ul>	without
<ul style="list-style-type: none"> <li>• Ground fault protection</li> </ul>	No
<ul style="list-style-type: none"> <li>• for neutral conductors / Short-circuit and overload proof</li> </ul>	No
<ul style="list-style-type: none"> <li>• Overload protection</li> </ul>	No

### Short circuit

Operational short-circuit current breaking capacity (Ics)	
<ul style="list-style-type: none"> <li>• at 240 V / rated value</li> </ul>	75 kA
<ul style="list-style-type: none"> <li>• at 415 V / rated value</li> </ul>	70 kA
<ul style="list-style-type: none"> <li>• at 500 V / rated value</li> </ul>	30 kA
<ul style="list-style-type: none"> <li>• at 690 V / rated value</li> </ul>	8 kA
Maximum short-circuit current breaking capacity (Icu)	
<ul style="list-style-type: none"> <li>• at 240 V / rated value</li> </ul>	100 kA

• at 415 V / rated value	70 kA
• at 440 V / rated value	50 kA
• at 480 V / acc. to NEMA / rated value	50 kA
• at 500 V / rated value	40 kA
• at 600 V / acc. to NEMA / rated value	20 kA
• at 690 V / rated value	15 kA

## Connections

Arrangement of electrical connectors / for main current circuit	front side
<b>Type of connectable conductor cross-sections</b>	
• for main contacts / with flexible busbar	25 x 10
• for main contacts / solid	50 ... 300 mm <sup>2</sup>
• for main contacts / finely stranded / with core end processing	50 ... 240 mm <sup>2</sup>
• for main contacts / stranded	50 ... 300 mm <sup>2</sup>
• for auxiliary contacts / solid	0.75 ... 1.5 mm <sup>2</sup>
• for auxiliary contacts / finely stranded / with core end processing	0,75 ... 1.0 mm <sup>2</sup>
Type of electrical connection / for main current circuit	screw-type terminals

## Mechanical Design



Height	279.5 mm
Width	139 mm
Depth	163.5 mm
Mounting type	fixed mounting





## Environmental conditions

Ambient temperature	
• during operation / minimum	0 °C
• during operation / maximum	70 °C
• during storage / minimum	-40 °C
• during storage / maximum	80 °C

## Certificates

Certificate of suitability	IEC, high switching capacity (H)
Reference code	
• acc. to DIN EN 61346-2	Q

General Product Approval		EMC	Declaration of Conformity	Test Certificates
 CCC	<a href="#">Miscellaneous</a>	<a href="#">KC</a>	 C-Tick	 EG-Konf.
				<a href="#">Special Test Certificate</a>

Shipping Approval					
 ABS	 BUREAU VERITAS	 LRS	 PRS	 RINA	 RMRS

other		
<a href="#">Environmental Confirmations</a>	<a href="#">Miscellaneous</a>	<a href="#">Confirmation</a>

### Further information

**Information- and Downloadcenter (Catalogs, Brochures,...)**

<http://www.siemens.com/lowvoltage/catalogs>

**Industry Mall (Online ordering system)**

<https://mall.industry.siemens.com/mall/en/en/Catalog/product?mlfb=3VL4740-2DE36-0AA0>

**Service&Support (Manuals, Certificates, Characteristics, FAQs,...)**

<https://support.industry.siemens.com/cs/ww/en/ps/3VL4740-2DE36-0AA0>

**Image database (product images, 2D dimension drawings, 3D models, device circuit diagrams, ...)**

[http://www.automation.siemens.com/bilddb/cax\\_en.aspx?mlfb=3VL4740-2DE36-0AA0](http://www.automation.siemens.com/bilddb/cax_en.aspx?mlfb=3VL4740-2DE36-0AA0)

**CAX-Online-Generator**

<http://www.siemens.com/cax>

**Tender specifications**

<http://www.siemens.com/specifications>